

**AGENDA**  
**PUBLIC WORKS & UTILITIES COMMITTEE**  
**Village of Hoffman Estates**

**February 24, 2020**

*Immediately following Finance Committee*

|          |                                 |                          |
|----------|---------------------------------|--------------------------|
| Members: | Anna Newell, Chairperson        | Gary G. Stanton, Trustee |
|          | Michael Gaeta, Vice Chairperson | Karen J. Arnet, Trustee  |
|          | Gary Pilafas, Trustee           | William McLeod, Mayor    |
|          | Karen V. Mills, Trustee         |                          |

- I. Roll Call**
- II. Approval of Minutes – January 27, 2020**

**NEW BUSINESS**

1. Request approval for the Historical Sites Commission to proceed with 2020 budgeted activities and events, in an amount not to exceed \$1,100.
2. Request authorization to enter a service agreement with Enel X Inc. to participate in their Emergency Demand Response Program
3. Request authorization to award contract for 2020 Parkway Tree Planting Program to St. Aubin Nursery of Kirkland, IL (low bid) in an amount not to exceed \$100,000.
4. Request authorization to award contract for 2020 Contractor Parkway Tree Trimming Program to use Advanced Tree Care of Lincolnshire, IL (low bid) in an amount not to exceed \$50,000.
5. Request authorization to award contract for 2020 Contracted Branch/Brush Pickup Program to Lucas Landscape and Design, Deerfield, IL (low bid) in an amount not to exceed \$40,000.
6. Request authorization to waive bidding and purchase replacement Transportation and Engineering Division vehicle Unit E98 through the Northwest Municipal Conference Suburban Purchasing Cooperative from Currie Motors, Frankfort, IL, in an amount not to exceed \$27,676.
7. Discussion regarding and authorization to:
  - a) selection of a sign design and color for an electronic message board and entryway sign; and
  - b) Waive bidding and award contract for the installation of an electronic message board and entryway sign at the Village Hall to Quantum Sign Corp., Sugar Grove, IL in an amount not to exceed \$52,730.

**REPORTS (INFORMATION ONLY)**

1. Department of Public Works Monthly Report.
2. Department of Development Services Monthly Engineering Report of the Transportation and Engineering Division.

**III. President's Report**

**IV. Other**

**V. Items in Review**

**VI. Adjournment**

*(Further details and information can be found in the agenda packet attached hereto and incorporated herein and can also be viewed online at [www.hoffmanestates.org](http://www.hoffmanestates.org) and/or in person in the Village Clerk's office).*

*The Village of Hoffman Estates complies with the Americans with Disabilities Act (ADA). For accessibility assistance call the ADA Coordinator at 847/882-9100.*

**PUBLIC WORKS & UTILITIES COMMITTEE  
MEETING MINUTES**

**DRAFT  
January 27, 2020**

**I. Roll call**

**Members in Attendance:**

**Trustee Anna Newell, Chairperson  
Trustee Michael Gaeta, Vice Chairperson  
Trustee Karen Mills  
Trustee Gary Pilafas  
Trustee Gary Stanton  
Trustee Karen Arnet  
Mayor William McLeod**

**Management Team Members  
in Attendance:**

**James Norris, Village Manager  
Dan O'Malley, Deputy Village Manager  
Arthur Janura, Corporation Counsel  
Mark Koplun, Sears Centre Rep  
Patti Cross, Asst. Corporation Counsel  
Patrick Fortunato, Fire Chief  
Ted Bos, Police Chief  
Kasia Cawley, Asst. Police Chief  
Audra Marks, Asst. Director of HHS  
Joe Nebel, Director of Public Works  
Rachel Musiala, Finance Director  
Paul Petrenko, Facilities Manager  
Fred Besenhoffer, Director of IS  
Ben Gibbs, Sears Centre Arena  
Suzanne Ostrovsky, Asst. to the Village Mgr.**

The Public Works & Utilities Committee meeting was called to order at 7:31 p.m.

**II. Approval of Minutes – December 9, 2019**

Motion by Trustee Gaeta, seconded by Trustee Arnet, to approve the minutes of the Public Works & Utilities Committee meeting of December 9, 2019. Voice vote taken. All ayes. Motion carried.

**NEW BUSINESS**

- 1. Request authorization to waive bidding and purchase Neptune meters from Water Resources, Inc., Elgin, IL (sole supplier), at 2020 unit prices, in an amount not to exceed \$50,000.**

An item summary sheet from Joe Nebel and Haileng Xia was presented to Committee.

Trustees also inquired about public notices for the upcoming Meter Change Program and when they would be mailed. Mr. Nebel and Mr. Norris provided background and comments and indicated letters would be mailed to residents by mid to end of February.

Mayor McLeod asked about the process if there was no response from the resident. Mr. Nebel commented.

Motion by Trustee Gaeta, seconded by Trustee Pilafas, to purchase Neptune meters from Water Resources, Inc., Elgin, IL (sole supplier), at 2020 unit prices, in an amount not to exceed \$50,000. Voice vote taken. All ayes. Motion carried.

- 2. Request authorization to waive bidding and purchase one trailer mounted 2020 Vermeer Model BC1800 Brush/Branch Chipper through Vermeer Midwest, Inc., Aurora, IL (Sourcewell Cooperative Purchasing Program) in an amount not to exceed \$86,848.**

An item summary sheet from Joe Nebel, Kelly Kerr and Joe Capiga was presented to Committee.

Motion by Trustee Gaeta, seconded by Trustee Stanton, to purchase one trailer mounted 2020 Vermeer Model BC1800 Brush/Branch Chipper through Vermeer Midwest, Inc., Aurora, IL (Sourcewell Cooperative Purchasing Program) in an amount not to exceed \$86,848. Voice vote taken. All ayes. Motion carried.

- 1. Discussion regarding a policy allowing placement of signs for community service and civic organizations at the location of Village entry-way and/or population signs.**

An item summary sheet from James Norris and Art Janura was presented to Committee.

Mr. Norris provided background on the discussion and noted the staff recommendation.

Trustee Pilafas noted the request by the Schaumburg/Hoffman Estates Rotary to be included on signage. Trustees and Mr. Norris discussed various scenarios.

### **REPORTS (INFORMATION ONLY)**

- 1. Department of Public Works Monthly Report.**

The Department of Public Works Month Report was received and filed.

- 2. Department of Development Services Monthly Engineering Report of the Transportation and Engineering Division.**

The Department of Development Services Monthly Engineering Report of the Transportation and Engineering Division was received and filed.

**III. President's Report**

**IV. Other**

**V. Items in Review**

**VI. Adjournment**

Motion by Trustee Gaeta, seconded by Trustee Stanton, to adjourn the meeting at 7:50 p.m. Voice vote taken. All ayes. Motion carried.

Minutes submitted by:

---

Jennifer Djordjevic, Director of Operations  
and Outreach / Office of the Mayor & Board

---

Date

**COMMITTEE AGENDA ITEM  
VILLAGE OF HOFFMAN ESTATES**

**SUBJECT:** Request approval for the Historical Sites Commission to proceed with 2020 budgeted activities and events, in an amount not to exceed \$1,100.

**MEETING DATE:** February 24, 2020

**COMMITTEE:** Public Works & Utilities

**FROM:** Joseph Nebel, Director of Public Works  
Paul Petrenko, Staff Liaison

---

**PURPOSE:** Approval for Historical Sites Commission to proceed with 2020 budgeted activities and events.

**BACKGROUND:** 2020 budget allocations for the Historical Sites Commission include funding to hold several planned projects and events.

**DISCUSSION:** *Spring Event - March 21, 2020 - 10:00 a.m. -12:00 p.m.*  
The Historical Sites Commission invites old house enthusiasts to visit "Our Old House". Examine the history of the 1856 house in the room layout, floors, staircase, and basement. Our National Register listed Milwaukee cream brick smokehouse will also be open. Photos, blue prints and maps will be on display. \$200 is budgeted, refreshments will be served.

*Greve Cemetery Tours - April 26, 2020 and September 27, 2020, 1:00 p.m.*

Small group guided tour of Greve Cemetery – weather permitting. This is a free event.

*Sunderlage Open House – July 19, 2020 1:00 p.m. – 4:00 p.m.*  
\$550 is budgeted. Program content yet to be determined.

*Potential Fall Event – Oct. 25, 2020 -* Program content yet to be determined, if event is scheduled.

**DISCUSSION (continued):*****December 5, 2020 – Teddy Bear Holiday Stories; starts promptly at 1:00 p.m.***

This is an annual favorite. The Sunderlage House is decorated with a holiday tree trimmed with teddy bears. This is particularly appealing to children as well as to their parents. There is no charge for admission, but reservations are required. There is a visit from Santa, story time, a gift of a small bear from the tree, and refreshments. \$150 is budgeted.

**FINANCIAL IMPACT:**

In summary, the following activities are earmarked for accomplishment during fiscal year 2020:

| <b>2020 Activities</b>                     | <b>Cost</b>   |
|--|---------------|
| March 21 – Spring Event                    | \$200         |
| April 26 & Sept. 27 - Greve Cemetery Tours | \$0           |
| July 21 – Sunderlage Open House            | \$550         |
| October 25- Potential Fall Event           | \$200         |
| December 5 – Teddy Bear Holiday Stories    | \$150         |
| <b>Total</b>                               | <b>\$1100</b> |

**RECOMMENDATION:**

Request approval for the Historical Sites Commission to proceed with 2020 budgeted activities and events, in an amount not to exceed \$1,100.

**COMMITTEE AGENDA ITEM  
VILLAGE OF HOFFMAN ESTATES**

**SUBJECT:** Request authorization to enter a service agreement with Enel X Inc. to participate in their Emergency Demand Response Program.

**MEETING DATE:** February 24, 2020

**COMMITTEE:** Finance

**FROM:** Joseph Nebel, Director of Public Works  
Paul Petrenko, Facilities Manager

---

---

**PURPOSE:** To receive a continuous revenue stream for participation in Enel X Inc. program of Emergency Demand Response by managing curtailable electrical capacity at three (3) Village facilities.

**BACKGROUND:** The Village has been participating in a voluntary Emergency Demand Response with Enel X (formerly EnerNoc) since 2011. After some early contract adjustments, the Village established the Village Hall, Police, and Sears Centre Arena facilities to be the main participating buildings in the program.

Although we have never been activated for an actual demand response event, we have enjoyed a steady revenue stream from being available to shed electrical load off of the ComEd grid should it be necessary to do so. Our revenues averaged approximately \$20,000 to \$25,000 per year until 2017 when the Sears Centre Arena Generac generator had to be removed from the program. This was due to changes in the EPA's emissions standards on generators used for demand response purposes.

As a result, Public Works requested Board approval for the installation of an underutilized 900 kW mobile generator at the Sears Centre Arena which would meet the EPA Tier 2 emissions requirements, allow the arena to once again be allowed back into the Emergency Demand Response program, and once again generate additional revenues for the Village.



**DISCUSSION:**

When the arena generator installation project was completed, a number of positive developments had taken place. Enel X verified proof of Tier 2 status and is currently processing all the necessary EPA permitting. Capacity prices have increased and, with our previous 3 year agreement up for renewal (last one was renewed in 2017), Enel X is raising our split from 38% to 58%. This is due to our past excellent performance and the state of the market. The program now runs year round, with a summer and a winter component further enhancing revenues.

In the new proposed service agreement, should an emergency event occur, such as a heat or cold wave, Enel X will provide a one-half (1/2) hour notification to the Village to implement the predetermined energy reduction target at the 3 facilities. There is no performance penalty for a failure to meet, or implement the targeted reduction during the response event. However, our earnings would be reduced.

Event duration would typically be 4 hours between the hours of 10:00 am and 10:00 pm during peak events. There have been no events called in the ComEd zone since participating in the Enel X Emergency Demand Response program back in 2011.

**FINANCIAL IMPACT:**

Based on the combined estimated capacity of 899 kW for the Sears Centre Arena, the Police Station, and the Village Hall, total base revenue for the 2020-2022 period is estimated to be \$72,975 (see Enel X Emergency Demand Response Estimate). Since the capacity rates have not been published yet for the 2023 season, they have not been included in this projection. If the rates stay the same however, we can anticipate the total base revenue over the term of this agreement to be approximately \$110,462.00.

This does not include any additional revenue from energy payments during an event. This is an annual program that would provide continuous revenues to the Village and will make a significant contribution to our overall energy reduction strategy.

**RECOMMENDATION:**

Request authorization to enter a service agreement with Enel X Inc. to participate in their Emergency Demand Response Program.

**COMMITTEE AGENDA ITEM  
VILLAGE OF HOFFMAN ESTATES**

**SUBJECT:** Request authorization to award contract for 2020 Parkway Tree Planting Program to St. Aubin Nursery of Kirkland, IL (low bid) in an amount not to exceed \$100,000.

**MEETING DATE:** February 24, 2020

**COMMITTEE:** Public Works & Utilities

**FROM:** Joseph Nebel, Director of Public Works  
Kelly Kerr, Asst. Director of Public Works  
Nick Lackowski, Village Forester

---

---

**PURPOSE:** To award a contract for 2020 Parkway Tree Planting Program.

**BACKGROUND:** This is an annual budgeted program whereby the Village purchases and plants parkway trees for a) subdivisions based on deposits collected from building permits, b) replacement tree plantings from accidents and storm damage, and for c) parkway tree plantings utilized to increase aesthetic value for various Village projects. Specifications were prepared and mailed requesting bids from contractors for the performance of this work and included options for extension of the contract for the respective 2021 and 2022 seasons. Planting of these trees occurs in fall with select species planted in the spring based on nursery recommendations for best chance of survivability.

**DISCUSSION:** On January 30, 2020 three (3) bids were opened and staff began an evaluation process. After reviewing the bids received it was determined that the St. Aubin Nursery had submitted the lowest bid.

St. Aubin Nursery is known to the Village of Hoffman Estates for parkway tree planting services. St Aubin Nursery planted a total of 2,500+ quality trees in conjunction with a number of village programs, including the Emerald Ash

**DISCUSSION: (continued)**

Borer replacement program. The availability and quality of installation of product has for the most part exceeded expectations by the village. The village has utilized St. Aubin Nursery for tree planting programs over the last 25+ years.

A comparison/tabulation of the three (3) bid proposals is attached.

**FINANCIAL IMPACT:**

The Village reserves the right to change, add or delete quantities of trees to be planted. This quantity is conditioned upon the total amount of funds budgeted for the program each fiscal year as well as the rate of completion of homes in subdivisions and was indicated in the bid specifications.

Given our ability to control the quantity of trees the contractor will be planting, staff can cause the contract sum to be equal to that of funding availability. Based on specifications requirements, bidders submitted prices per tree to be planted by specie as indicated on the attached tabulation form.

Funding for this year's program is supported by \$59,750 budgeted within the Street Division Forestry & Grounds Program; Accident, storm damage, and out of warranty replacement plantings (\$35,000), planting/replanting of Village rights-of-way (\$11,750), Arbor Day & beautification plantings (\$3,000), and Beatification plantings (\$1,500) as well as (\$10,000) slated for village hall landscape improvements. Separate escrow account funding for subdivision plantings (\$40,250) is also included. This will permit approximately 330 trees to be planted in conjunction with these various programs for the 2020 season.

**RECOMMENDATION:**

Request authorization to award contract for 2020 Parkway Tree Planting Program to St. Aubin Nursery of Kirkland, IL (low bid) in an amount not to exceed \$100,000.

**Note: Bid Specifications and individual bids are in the white binder in the Trustee's ante room.**

STATE OF ILLINOIS  
VILLAGE OF HOFFMAN ESTATES  
2020 Partway Tree Planting Program  
TABULATION OF BIDS

| County: Cook<br>Municipality or Road District: Hoffman Estates<br>Section:<br>Estimate \$<br>Proposal Guarantees:<br>2020 Bid Season | Date: 1/30/2020<br>Time: 10:00 a.m.<br>Appropriation \$<br>Attended by: Nick Lackowski | Company     | \$4 Aubin Nursery<br>Kirkland II |              | Beary Landscape<br>Management<br>Des Plaines II |              | Apex Landscaping<br>Inc. Hawthorn Woods II |              |
|--|--|-------------|----------------------------------|--------------|---|--------------|--|--------------|
|  |  | BID DEPOSIT | Bond                             |              | Bond  |              | Bond                                       |              |
|  |  | AMOUNT      | \$2,900.00                       |              | \$2,600.00                                      |              | \$2,000.00                                 |              |
| 2020 Proposed Cost:  | Shade Trees  | QUANTITY    | Unit Price                       | Total        | Unit Price                                      | Total        | Unit Price                                 | Total        |
| Acer x freemania - Freeman Maple 'Autumn Blaze'  |  | 15-25       | \$265.00                         | \$7,125.00   | \$425.00  | \$10,625.00  | \$438.79                                   | \$10,869.75  |
| Acer platanoides - Norway Maple 'Emerald Lustre' or 'Emerald Queen'  |  | 0-10        | \$285.00                         | \$2,850.00   | \$425.00  | \$4,250.00   | \$481.07                                   | \$4,810.70   |
| Acer miyabei - State Street Maple  |  | 15-25       | \$305.00                         | \$7,625.00   | \$425.00  | \$10,625.00  | \$468.37                                   | \$11,659.25  |
| Platanus x acerifolia - London Plane Tree  |  | 10-20       | \$319.00                         | \$6,380.00   | \$425.00  | \$8,500.00   | \$481.07                                   | \$9,221.40   |
| Carpinus Caroliniana - American Hornbeam   |  | 10-20       | \$319.00                         | \$6,380.00   | \$425.00  | \$8,500.00   | \$481.07                                   | \$9,221.40   |
| Gleditsia triacanthos 'Inermis' - Thornless Honeylocust 'Skyline' or 'Shademaster'   |  | 15-25       | \$319.00                         | \$7,975.00   | \$425.00  | \$10,625.00  | \$481.07                                   | \$11,528.75  |
| Tilia cordata - Littleleaf Linden 'Glenleven' or 'Greenspire'  |  | 10-20       | \$265.00                         | \$5,300.00   | \$425.00  | \$8,500.00   | \$487.50                                   | \$9,751.50   |
| Tilia Americana - American Linden  |  | 10-20       | \$290.00                         | \$5,800.00   | \$425.00  | \$8,500.00   | \$487.50                                   | \$9,751.50   |
| Tilia tomentosa - Silver Linden  |  | 10-20       | \$280.00                         | \$5,600.00   | \$425.00  | \$8,500.00   | \$487.50                                   | \$9,751.50   |
| Gymnocladus dioica - Kentucky Coffeetree   |  | 5-15        | \$295.00                         | \$4,425.00   | \$425.00  | \$6,375.00   | \$471.67                                   | \$7,075.05   |
| Quercus bicolor - Swamp White Oak  |  | 5-15        | \$300.00                         | \$4,500.00   | \$450.00  | \$6,750.00   | \$487.00                                   | \$7,005.00   |
| Quercus macrocarpa - Bur Oak   |  | 0-10        | \$270.00                         | \$2,700.00   | \$450.00  | \$4,500.00   | \$482.75                                   | \$4,827.50   |
| Quercus muehlenbergii - Chinkapin Oak  |  | 5-15        | \$270.00                         | \$4,050.00   | \$450.00  | \$6,750.00   | \$482.75                                   | \$7,241.25   |
| Quercus imbricaria - Shingle Oak   |  | 0-10        | \$360.00                         | \$3,600.00   | \$450.00  | \$4,500.00   | \$482.75                                   | \$4,827.50   |
| Quercus rubra - Red Oak  |  | 0-5         | \$310.00                         | \$1,550.00   | \$450.00  | \$2,250.00   | \$482.75                                   | \$2,413.75   |
| Calluna speciosa - Catalpa   |  | 5-15        | \$300.00                         | \$4,500.00   | \$425.00  | \$6,375.00   | \$444.85                                   | \$6,674.25   |
| Betula nigra - River Birch   |  | 10-20       | \$270.00                         | \$5,400.00   | \$337.00  | \$6,740.00   | \$420.20                                   | \$8,584.00   |
| Linodendron tulipifera - Tuliptree   |  | 10-25       | \$310.00                         | \$7,750.00   | \$425.00  | \$10,625.00  | \$451.25                                   | \$11,281.25  |
| Liquidambar styraciflua - Sweet Gum  |  | 0-5         | \$320.00                         | \$1,600.00   | \$425.00  | \$2,125.00   | \$498.50                                   | \$2,482.50   |
| Celtis occidentalis - Hackberry  |  | 10-20       | \$270.00                         | \$5,400.00   | \$425.00  | \$8,500.00   | \$435.50                                   | \$8,710.00   |
| Ginkgo biloba - Ginkgo   |  | 5-15        | \$340.00                         | \$5,100.00   | \$810.00  | \$9,265.00   | \$500.00                                   | \$7,535.00   |
| Ulmus 'Morton' - Accolade Elm  |  | 10-25       | \$285.00                         | \$7,125.00   | \$425.00  | \$10,625.00  | \$458.50                                   | \$11,412.50  |
| Ulmus x 'Morton Glossy' - Triumph Elm  |  | 10-25       | \$285.00                         | \$7,125.00   | \$425.00  | \$10,625.00  | \$451.25                                   | \$11,281.25  |
| Ulmus x 'Patrol' - Patrol Elm  |  | 10-20       | \$300.00                         | \$6,000.00   | \$425.00  | \$8,500.00   | \$440.75                                   | \$8,815.00   |
| Ulmus x 'Regal' - Regal Elm  |  | 10-20       | \$275.00                         | \$5,500.00   | \$425.00  | \$8,500.00   | NO BID                                     | \$0.00       |
| Carpinus Caroliniana - American Hornbeam   |  | 5-10        | \$330.00                         | \$3,300.00   | \$425.00  | \$4,250.00   | \$468.37                                   | \$4,683.70   |
| Cladrasia Kentuckea - Yellowwood   |  | 5-10        | \$330.00                         | \$3,300.00   | \$425.00  | \$4,250.00   | \$507.73                                   | \$5,077.30   |
| Taxodium distichum - Baldcypress   |  | 5-15        | \$280.00                         | \$3,750.00   | \$425.00  | \$6,375.00   | \$434.55                                   | \$6,518.25   |
| Aesculus flava - Yellow Buckeye  |  | 10-25       | \$250.00                         | \$6,250.00   | \$425.00  | \$10,625.00  | \$474.85                                   | \$11,871.25  |
| Alnus glutinosa - Black Alder  |  | 0-10        | \$290.00                         | \$2,900.00   | \$425.00  | \$4,250.00   | \$434.55                                   | \$4,345.50   |
| <b>Total Bid</b>   |  |             |                                  | \$150,760.00 |   | \$221,400.00 |  | \$228,215.85 |

STATE OF ILLINOIS  
 VILLAGE OF HOFFMAN ESTATES  
 2020 Parkway Tree Planting Program  
 TABULATION OF BIDS

|  |                             |                 |                   |                    |                   |                    |                   |                    |
|--|-----------------------------|-----------------|-------------------|--------------------|-------------------|--------------------|-------------------|--------------------|
| County: Cook   | Date: 1/30/2020             |                 |                   |                    |                   |                    |                   |                    |
| Municipality or Road District: Hoffman Estates           | Time: 10:00 a.m.            |                 |                   |                    |                   |                    |                   |                    |
| Section:   | Appropriation \$            |                 |                   |                    |                   |                    |                   |                    |
| Estimate \$  | Attended by: Nick Lackowski |                 |                   |                    |                   |                    |                   |                    |
| Proposal Guarantee:                                      |                             |                 |                   |                    |                   |                    |                   |                    |
| 2020 Bid Season  |                             |                 |                   |                    |                   |                    |                   |                    |
| <b>2020 Proposed Cost:</b>                               | <b>Ornamental Trees</b>     | <b>QUANTITY</b> | <b>Unit Price</b> | <b>Total</b>       | <b>Unit Price</b> | <b>Total</b>       | <b>Unit Price</b> | <b>Total</b>       |
| Acer latanicum - Tartarian Maple                         |                             | 5-10            | \$289.00          | 2,890.00           | \$425.00          | \$4,250.00         | NO BID            | \$0.00             |
| Acer campestre - Hedge Maple                             |                             | 0-10            | \$260.00          | 2,600.00           | \$425.00          | \$4,250.00         | \$458.50          | \$4,585.00         |
| Acer ginnala - Amur Maple Tree Form                      |                             | 0-10            | \$290.00          | 2,900.00           | \$425.00          | \$4,250.00         | \$435.50          | \$4,355.00         |
| Amelanchier - Serviceberry Tree Form                     |                             | 5-15            | \$315.00          | 4,725.00           | \$425.00          | \$8,375.00         | \$440.75          | \$6,811.25         |
| Cercis canadensis- Eastern Redbud                        |                             | 0-10            | \$315.00          | 3,150.00           | \$425.00          | \$4,250.00         | \$443.50          | \$4,435.00         |
| Malus Species - Ornamental Crabapple 'Spring Snow'       |                             | 0-10            | \$300.00          | 3,000.00           | \$258.00          | \$2,580.00         | \$383.50          | \$3,835.00         |
| Malus species - Ornamental Crabapple 'Red Baron'         |                             | 0-10            | \$300.00          | 3,000.00           | \$258.00          | \$2,580.00         | NO BID            | \$0.00             |
| Malus Species - Ornamental Crabapple - 'Prairie Fire'    |                             | 0-10            | \$295.00          | 2,950.00           | \$258.00          | \$2,580.00         | \$387.44          | \$3,874.40         |
| Crataegus Crus-Grill Inermis-Thornless Cockspur Hawthorn |                             | 0-10            | \$320.00          | 3,200.00           | \$258.00          | \$2,580.00         | \$428.18          | \$4,281.80         |
| Syringa reticulata - Japanese Tree Lilac 'Ivory Silk'    |                             | 15-25           | \$325.00          | 8,125.00           | \$425.00          | \$10,625.00        | \$482.88          | \$12,072.00        |
| Magnolia acuminata - Cucumber Magnolia                   |                             | 5-10            | \$320.00          | 3,200.00           | \$485.00          | \$4,950.00         | \$486.37          | \$4,863.70         |
| <b>Total Bid</b>   |                             |                 |                   | <b>\$38,740.00</b> |                   | <b>\$48,310.00</b> |                   | <b>\$48,883.25</b> |

STATE OF ILLINOIS  
VILLAGE OF HOFFMAN ESTATES  
2820 Parkway Tree Planting Program  
TABULATION OF BIDS

|   |                             |          |                                 |  |              |   |              |
|---|-----------------------------|----------|---------------------------------|--|--------------|---|--------------|
| County: Cook  | Date: 1/30/2020             | Company  | St Aubin Nursery<br>Kirkland II | Bary Landscape<br>Management<br>Des Plaines II |              | Apex Landscaping<br>Inc. Hawthorn Woods II. |              |
| Municipality or Road District: Hoffman Estates                            | Time: 10:00 a.m.            |          |                                 | Unit Price                                     | Total        | Unit Price                                  | Total        |
| Section:  | Appropriation \$            | QUANTITY | Unit Price                      | Total  | Unit Price   | Total                                       | Total        |
| Estimate \$   | Attended by: Nick Lackowski |          |                                 |  |              |   |              |
| Proposal Guarantee:   |                             |          |                                 |  |              |   |              |
| 2020 Bid Season   |                             |          |                                 |  |              |   |              |
| 2020 Proposed Cost:   | Evergreens & Shrubs         |          |                                 |  |              |   |              |
| Thuja occidentalis - Arborvitae 'Techny' or 'Pyramidal American'          | 0-10                        | \$225.00 | \$2,250.00                      | \$180.00                                       | \$1,800.00   | \$362.25                                    | \$3,622.50   |
| Picea pungens - Colorado Blue Spruce 'Hoops'                              | 0-3                         | \$240.00 | \$720.00                        | \$425.00                                       | \$1,275.00   | \$518.75                                    | \$1,559.25   |
| Euonymus alatus - Burning Bush 'Rudy Haag' or 'True Dwarf'                | 0-10                        | \$35.00  | \$350.00                        | \$36.00  | \$360.00     | \$98.31                                     | \$983.10     |
| Spiraea japonica - Spiraea 'Shirobana' or 'Little Princess'               | 0-6                         | \$40.00  | \$240.00                        | \$43.00  | \$258.00     | \$101.20                                    | \$607.20     |
| Syringa meyeri - Dwarf Korean Lilac                                       | 0-8                         | \$45.00  | \$270.00                        | \$43.00  | \$258.00     | \$101.20                                    | \$607.20     |
| Syringa pubescens subsp. Pauciflora - Dwarf Lilac 'Miss Kim'              | 0-10                        | \$45.00  | \$450.00                        | \$43.00  | \$430.00     | \$101.20                                    | \$1,012.00   |
| Viburnum dentatum - Arrowwood Viburnum 'Autumn Jazz' or 'Chicago Lusture' | 0-5                         | \$45.00  | \$270.00                        | \$43.00  | \$258.00     | \$83.00                                     | \$558.30     |
| Taxus media - Japanese Yew (low growing variety)                          | 0-15                        | \$49.00  | \$735.00                        | \$67.00  | \$1,005.00   | \$121.68                                    | \$1,625.20   |
| Buxus microphylla - Boxwood 'Wintergreen' or 'Green Velvet'               | 0-25                        | \$60.00  | \$1,500.00                      | \$148.00                                       | \$3,850.00   | \$112.75                                    | \$2,818.75   |
| Ribes alpinum - Alpine Currant  | 0-5                         | \$45.00  | \$225.00                        | \$43.00  | \$215.00     | \$98.10                                     | \$495.60     |
| Cornus sericea - Dogwood 'Isanti' or 'Allemani's Compact'                 | 0-5                         | \$45.00  | \$225.00                        | \$43.00  | \$215.00     | \$95.43                                     | \$477.15     |
| <b>Total Bid</b>  |                             |          | \$7,235.00                      |  | \$9,724.00   |   | \$14,680.21  |
| <b>2019 Cumulative Bid</b>  |                             |          | \$187,735.00                    |  | \$280,434.00 |   | \$292,875.31 |

STATE OF ILLINOIS  
VILLAGE OF HOFFMAN ESTATES  
2021 Parkway Tree Planting Program  
TABULATION OF BIDS

|   |  |                                 |                                 |  |  |              |            |              |
|---|--|---------------------------------|---------------------------------|--|--|--------------|------------|--------------|
| County: Cook<br>Municipality or Road District: Hoffman Estates<br>Section:<br>Estimate \$<br>Proposal Guarantee:<br>2021 Alternate Bid Season | Date: 1/30/2020<br>Time: 10:00 a.m.<br>Appropriation \$<br>Attended by: Nick Lackowski | Company                         | St Aubin Nursery<br>Kirkland II | Beary Landscape<br>Management<br>Dee Plance II | Apex Landscaping<br>Inc. Hawthorn Woods IL |              |            |              |
|   |  | BID DEPOSIT                     | Bond                            | Bond   | Bond                                       |              |            |              |
|   |  | AMOUNT                          | \$2,000.00                      | \$2,000.00                                     | \$2,000.00                                 |              |            |              |
|   |  | 2021 Proposed Cost: Shade Trees |                                 |  |  |              |            |              |
|   |  | QUANTITY                        | Unit Price                      | Total  | Unit Price                                 | Total        | Unit Price | Total        |
| Acer x freemanii - Freeman Maple "Autumn Blaze"   |  | 15-25                           | \$290.00                        | \$7,250.00                                     | \$425.00                                   | \$10,625.00  | \$438.70   | \$10,969.75  |
| Acer platanoides - Norway Maple "Emerald Lustre" or "Emerald Queen"   |  | 0-10                            | \$305.00                        | \$3,050.00                                     | \$425.00                                   | \$4,250.00   | \$481.07   | \$4,810.70   |
| Acer nyrubel - Slate Street Maple   |  | 15-25                           | \$318.00                        | \$7,950.00                                     | \$425.00                                   | \$10,625.00  | \$468.37   | \$11,658.25  |
| Platanus x acerifolia - London Plane Tree   |  | 10-20                           | \$324.00                        | \$6,480.00                                     | \$425.00                                   | \$8,500.00   | \$481.07   | \$9,221.40   |
| Carpinus Caroliniana - American Hornbeam  |  | 10-20                           | \$319.00                        | \$6,380.00                                     | \$425.00                                   | \$8,500.00   | \$481.07   | \$9,221.40   |
| Gleditsia triacanthos "nervis" - Thornless Honeylocust "Skyline" or "Shademaster"   |  | 15-25                           | \$319.00                        | \$7,975.00                                     | \$425.00                                   | \$10,625.00  | \$481.07   | \$11,528.75  |
| Tilia cordata - Littleleaf Linden "Glenleven" or "Greenspire"   |  | 10-20                           | \$290.00                        | \$5,800.00                                     | \$425.00                                   | \$8,500.00   | \$487.58   | \$9,751.80   |
| Tilia Americana - American Linden   |  | 10-20                           | \$310.00                        | \$6,200.00                                     | \$425.00                                   | \$8,500.00   | \$487.58   | \$9,751.80   |
| Tilia tomentosa - Silver Linden   |  | 10-20                           | \$290.00                        | \$5,800.00                                     | \$425.00                                   | \$8,500.00   | \$487.58   | \$9,751.80   |
| Gymnocladus dioica - Kentucky Coffeetree  |  | 5-15                            | \$305.00                        | \$4,575.00                                     | \$425.00                                   | \$6,375.00   | \$471.67   | \$7,075.05   |
| Quercus bicolor - Swamp White Oak   |  | 5-15                            | \$310.00                        | \$4,650.00                                     | \$450.00                                   | \$6,750.00   | \$471.67   | \$7,075.05   |
| Quercus macrocarpa - Bur Oak  |  | 0-10                            | \$280.00                        | \$2,800.00                                     | \$450.00                                   | \$4,500.00   | \$487.58   | \$4,875.80   |
| Quercus muhlenbergii - Chinkapin Oak  |  | 5-15                            | \$290.00                        | \$4,350.00                                     | \$450.00                                   | \$6,750.00   | \$487.58   | \$7,313.70   |
| Quercus imbricaria - Shingle Oak  |  | 0-10                            | \$310.00                        | \$3,100.00                                     | \$450.00                                   | \$4,500.00   | \$487.58   | \$4,875.80   |
| Quercus rubra - Red Oak   |  | 0-5                             | \$315.00                        | \$1,575.00                                     | \$450.00                                   | \$2,250.00   | \$487.58   | \$2,437.90   |
| Callapa speciosa - Catalpa  |  | 5-15                            | \$315.00                        | \$4,725.00                                     | \$425.00                                   | \$6,375.00   | \$449.40   | \$6,741.00   |
| Betula nigra - River Birch  |  | 10-20                           | \$280.00                        | \$5,600.00                                     | \$337.00                                   | \$6,740.00   | \$433.49   | \$8,689.80   |
| Liriodendron tulipifera - Tuliptree   |  | 10-25                           | \$315.00                        | \$7,875.00                                     | \$425.00                                   | \$10,625.00  | \$455.26   | \$11,361.50  |
| Liquidambar styraciflua - Sweet Gum   |  | 0-5                             | \$325.00                        | \$1,625.00                                     | \$425.00                                   | \$2,125.00   | \$503.49   | \$2,517.45   |
| Celtis occidentalis - Hackberry   |  | 10-20                           | \$280.00                        | \$5,600.00                                     | \$425.00                                   | \$8,500.00   | \$439.86   | \$8,797.20   |
| Ginkgo biloba - Ginkgo  |  | 5-15                            | \$350.00                        | \$5,250.00                                     | \$819.00                                   | \$9,285.00   | \$814.00   | \$7,711.35   |
| Ulmus "Morton" - Accolade Elm   |  | 10-25                           | \$285.00                        | \$7,375.00                                     | \$425.00                                   | \$10,625.00  | \$481.07   | \$11,528.75  |
| Ulmus x "Morton Glossy" - Triumph Elm   |  | 10-25                           | \$285.00                        | \$7,375.00                                     | \$425.00                                   | \$10,625.00  | \$455.76   | \$11,394.00  |
| Ulmus x "Patriot" - Patriot Elm   |  | 10-20                           | \$310.00                        | \$6,200.00                                     | \$425.00                                   | \$8,500.00   | \$455.16   | \$9,103.20   |
| Ulmus x "Regal" - Regal Elm   |  | 10-20                           | \$285.00                        | \$5,700.00                                     | \$425.00                                   | \$8,500.00   | NO BID     | \$0.00       |
| Carpinus Caroliniana - American Hornbeam  |  | 5-10                            | \$340.00                        | \$3,400.00                                     | \$425.00                                   | \$4,250.00   | \$468.37   | \$4,683.70   |
| Cladonia pennsylvanica - Yellowwood   |  | 5-10                            | \$340.00                        | \$3,400.00                                     | \$425.00                                   | \$4,250.00   | \$507.73   | \$5,077.30   |
| Taxodium distichum - Baldcypress  |  | 5-15                            | \$265.00                        | \$3,975.00                                     | \$425.00                                   | \$6,375.00   | \$434.55   | \$6,518.25   |
| Aesculus flava - Yellow Buckeye   |  | 10-25                           | \$285.00                        | \$6,625.00                                     | \$425.00                                   | \$10,625.00  | \$474.85   | \$11,871.25  |
| Alnus glutinosa - Black Alder   |  | 0-10                            | \$295.00                        | \$2,950.00                                     | \$425.00                                   | \$4,250.00   | \$434.55   | \$4,345.50   |
| <b>Total Bid</b>  |  | -                               |                                 | \$155,610.00                                   |  | \$221,400.00 |            | \$250,435.80 |

**STATE OF ILLINOIS  
VILLAGE OF HOFFMAN ESTATES  
2021 Parkway Tree Planting Program  
TABULATION OF BIDS**

|  |                             |                 |                   |                    |                   |                    |                   |                    |  |
|--|-----------------------------|-----------------|-------------------|--------------------|-------------------|--------------------|-------------------|--------------------|--|
| County: Cook   | Date: 1/30/2020             |                 |                   |                    |                   |                    |                   |                    |  |
| Municipality or Road District: Hoffman Estates           | Time: 10:00 a.m.            |                 |                   |                    |                   |                    |                   |                    |  |
| Section:   | Appropriation \$            |                 |                   |                    |                   |                    |                   |                    |  |
| Estimate \$  | Attended by: Nick Lackowski |                 |                   |                    |                   |                    |                   |                    |  |
| Proposal Guarantee:                                      |                             |                 |                   |                    |                   |                    |                   |                    |  |
| 2021 Alternata Bid Season                                |                             |                 |                   |                    |                   |                    |                   |                    |  |
| <b>2021 Proposed Cost:</b>                               | <b>Ornamental Trees</b>     | <b>QUANTITY</b> | <b>Unit Price</b> | <b>Total</b>       | <b>Unit Price</b> | <b>Total</b>       | <b>Unit Price</b> | <b>Total</b>       |  |
| Acer tataricum - Tartarian Maple                         |                             | 5-10            | \$299.00          | 2,990.00           | \$425.00          | \$4,250.00         | NO BID            | \$0.00             |  |
| Acer campestre - Hedge Maple                             |                             | 0-10            | \$275.00          | 2,750.00           | \$425.00          | \$4,250.00         | \$481.07          | \$4,810.70         |  |
| Acer glabrate - Amur Maple Tree Form                     |                             | 0-10            | \$290.00          | 2,900.00           | \$425.00          | \$4,250.00         | \$439.68          | \$4,396.80         |  |
| Amelanchier - Serviceberry Tree Form                     |                             | 5-15            | \$325.00          | 4,875.00           | \$425.00          | \$8,375.00         | \$445.10          | \$8,677.40         |  |
| Cercis canadensis- Eastern Redbud                        |                             | 0-10            | \$335.00          | 3,350.00           | \$425.00          | \$4,250.00         | \$447.94          | \$4,479.40         |  |
| Malus Species - Ornamental Crabapple 'Spring Snow'       |                             | 0-10            | \$300.00          | 3,000.00           | \$259.00          | \$2,590.00         | \$397.44          | \$3,974.40         |  |
| Malus species - Ornamental Crabapple 'Red Baron'         |                             | 0-10            | \$300.00          | 3,000.00           | \$259.00          | \$2,590.00         | NO BID            | \$0.00             |  |
| Malus Species - Ornamental Crabapple - 'Prairie Fire'    |                             | 0-10            | \$295.00          | 2,950.00           | \$260.00          | \$2,500.00         | \$397.44          | \$3,974.40         |  |
| Crataegus Crus-Grill Inermis-Thornless Cockspur Hawthorn |                             | 0-10            | \$320.00          | 3,200.00           | \$259.00          | \$2,590.00         | \$428.10          | \$4,281.00         |  |
| Syringa reticulata - Japanese Tree Lilac 'Ivory Silk'    |                             | 15-25           | \$325.00          | 8,125.00           | \$425.00          | \$10,625.00        | \$492.88          | \$12,322.00        |  |
| Magnolia acuminata - Cucumber Magnolia                   |                             | 5-10            | \$320.00          | 3,200.00           | \$495.00          | \$4,050.00         | \$468.37          | \$4,683.70         |  |
| <b>Total Bid</b>   |                             |                 |                   | <b>\$40,340.00</b> |                   | <b>\$49,310.00</b> |                   | <b>\$49,362.50</b> |  |



STATE OF ILLINOIS  
VILLAGE OF HOFFMAN ESTATES  
2021 Parkway Tree Planting Program  
TABULATION OF BIDS

|   |                                |                 |                                 |  |   |                     |                   |                     |
|---|--------------------------------|-----------------|---------------------------------|--|---|---------------------|-------------------|---------------------|
| County: Cook  | Date: 1/30/2020                | Company         | St Aubin Nursery<br>Kirkland II | Deary Landscape<br>Management<br>Dee Plante II | Apex Landscaping<br>Inc. Hawthorn Woods II. |                     |                   |                     |
| Municipality or Road District: Hoffman Estates                            | Time: 10:00 a.m.               |                 |                                 |  |   |                     |                   |                     |
| Section:  | Appropriation \$               |                 |                                 |  |   |                     |                   |                     |
| Estimate \$   | Attended by: Nick Lackowski    |                 |                                 |  |   |                     |                   |                     |
| Proposal Guarantee:   |                                |                 |                                 |  |   |                     |                   |                     |
| 2021 Alternate Bid Season   |                                |                 |                                 |  |   |                     |                   |                     |
| <b>2021 Proposed Cost:</b>  | <b>Evergreens &amp; Shrubs</b> | <b>QUANTITY</b> | <b>Unit Price</b>               | <b>Total</b>                                   | <b>Unit Price</b>                           | <b>Total</b>        | <b>Unit Price</b> | <b>Total</b>        |
| Thuja occidentalis - Arborvitae 'Tachyn' or Pyramidal American'           |                                | 0-10            | \$225.00                        | \$2,250.00                                     | \$160.00                                    | \$1,600.00          | \$385.67          | \$3,658.70          |
| Picea pungens - Colorado Blue Spruce 'Hoops'                              |                                | 0-3             | \$240.00                        | \$720.00                                       | \$425.00                                    | \$1,275.00          | \$524.95          | \$1,574.85          |
| Euonymus alatus - Burning Bush 'Rudy Hardy' or 'True Dwarf'               |                                | 0-10            | \$35.00                         | \$350.00                                       | \$36.00                                     | \$360.00            | \$99.30           | \$993.00            |
| Spiraea japonica - Spiraea 'Shirobana' or 'Little Princess'               |                                | 0-8             | \$40.00                         | \$240.00                                       | \$43.00                                     | \$258.00            | \$102.21          | \$813.28            |
| Syringa meyeri - Dwarf Korean Lilac                                       |                                | 0-8             | \$45.00                         | \$270.00                                       | \$43.00                                     | \$258.00            | \$102.21          | \$813.28            |
| Syringa pubescens subsp. Patula - Dwarf Lilac 'Miss Kim'                  |                                | 0-10            | \$45.00                         | \$450.00                                       | \$43.00                                     | \$430.00            | \$102.21          | \$1,022.10          |
| Viburnum dentatum - Arrowwood Viburnum 'Autumn Jazz' or 'Chicago Lusture' |                                | 0-8             | \$45.00                         | \$270.00                                       | \$43.00                                     | \$258.00            | \$93.99           | \$563.94            |
| Taxus media - Japanese Yew (low growing variety)                          |                                | 0-15            | \$49.00                         | \$735.00                                       | \$87.00                                     | \$1,005.00          | \$122.84          | \$1,842.60          |
| Buxus microphylla - Boxwood 'Wintergreen' or 'Green Velvet'               |                                | 0-25            | \$60.00                         | \$1,500.00                                     | \$146.00                                    | \$3,650.00          | \$113.86          | \$2,847.00          |
| Ribes alpinum - Alpina Currant  |                                | 0-5             | \$45.00                         | \$225.00                                       | \$43.00                                     | \$215.00            | \$100.00          | \$500.00            |
| Comus sericea - Dogwood 'Isanti' or 'Alleman's Compact'                   |                                | 0-5             | \$45.00                         | \$225.00                                       | \$43.00                                     | \$215.00            | \$98.38           | \$481.90            |
| <b>Total Bid</b>  |                                |                 |                                 | <b>\$7,235.00</b>                              |   | <b>\$8,724.00</b>   |                   | <b>\$14,711.08</b>  |
| <b>2019 Cumulative Bid</b>  |                                |                 |                                 | <b>\$203,185.00</b>                            |   | <b>\$280,434.00</b> |                   | <b>\$294,529.18</b> |

STATE OF ILLINOIS  
VILLAGE OF HOFFMAN ESTATES  
2022 Parkway Tree Planting Program  
TABULATION OF BIDS

| County: Cook<br>Municipality or Road District: Hoffman Estates<br>Section:<br>Estimate \$<br>Proposal Guarantee:<br>2022 Alternate Bid Season | Date: 1/30/2020<br>Time: 10:00 a.m.<br>Appropriation \$<br>Attended by: Nick Lackowski | Company             | St Aubin Nursery<br>Kirkland II | Beary Landscape<br>Management<br>Dee Plante II | Apex Landscaping<br>Inc.Hawthorn Woods II. |            |             |
|---|--|---------------------|---------------------------------|--|--|------------|-------------|
|   |  | BID DEPOSIT         | Bond                            | Bond   | Bond                                       |            |             |
|   |  | AMOUNT              | \$2,000.00                      | \$2,000.00                                     | \$2,000.00                                 |            |             |
|   |  | 2022 Proposed Cost: | Shade Trees                     |  |  |            |             |
|   | QUANTITY   | Unit Price          | Total                           | Unit Price                                     | Total                                      | Unit Price | Total       |
| Acer x freemanii - Freeman Maple 'Autumn Blaze'   | 15-25  | \$295.00            | \$7,375.00                      | \$438.00                                       | \$10,950.00                                | \$443.18   | \$11,078.50 |
| Acer platanoides - Norway Maple 'Emerald Lustre' or 'Emerald Queen'   | 0-10   | \$315.00            | \$3,150.00                      | \$438.00                                       | \$4,380.00                                 | \$465.88   | \$4,658.80  |
| Acer nyctelab - State Street Maple  | 15-25  | \$325.00            | \$8,125.00                      | \$438.00                                       | \$10,950.00                                | \$471.88   | \$11,792.00 |
| Platanus x acerifolia - London Plane Tree   | 10-20  | \$329.00            | \$6,580.00                      | \$438.00                                       | \$8,760.00                                 | \$485.88   | \$9,313.60  |
| Carpinus Caroliniana - American Hornbeam  | 10-20  | \$310.00            | \$6,380.00                      | \$438.00                                       | \$8,760.00                                 | \$485.88   | \$9,313.60  |
| Gleditsia inacanthos 'nervis'-Thornless Honeylocust 'Skyline' or 'Shademaster'  | 15-25  | \$319.00            | \$7,975.00                      | \$438.00                                       | \$10,950.00                                | \$465.88   | \$11,642.00 |
| Tilia cordata - Littleleaf Linden 'Glenloven' or 'Greempire'  | 10-20  | \$295.00            | \$5,900.00                      | \$438.00                                       | \$8,760.00                                 | \$482.45   | \$9,849.00  |
| Tilia Americana - American Linden   | 10-20  | \$310.00            | \$6,200.00                      | \$438.00                                       | \$8,760.00                                 | \$482.45   | \$9,849.00  |
| Tilia tomentosa - Silver Linden   | 10-20  | \$295.00            | \$5,900.00                      | \$438.00                                       | \$8,760.00                                 | \$482.45   | \$9,849.00  |
| Gymnocladus dioica - Kentucky Coffeetree  | 5-15   | \$315.00            | \$4,725.00                      | \$438.00                                       | \$6,570.00                                 | \$478.39   | \$7,145.85  |
| Quercus bicolor - Swamp White Oak   | 5-15   | \$320.00            | \$4,800.00                      | \$463.00                                       | \$6,945.00                                 | \$478.39   | \$7,145.85  |
| Quercus macrocarpa - Bur Oak  | 0-10   | \$290.00            | \$2,900.00                      | \$463.00                                       | \$4,630.00                                 | \$482.45   | \$4,824.50  |
| Quercus muehlenbergii - Chinkapin Oak   | 5-15   | \$318.00            | \$4,650.00                      | \$463.00                                       | \$6,945.00                                 | \$482.45   | \$7,388.75  |
| Quercus imbricaria - Shingle Oak  | 0-10   | \$320.00            | \$3,200.00                      | \$463.00                                       | \$4,630.00                                 | \$482.45   | \$4,824.50  |
| Quercus rubra - Red Oak   | 0-5  | \$325.00            | \$1,625.00                      | \$463.00                                       | \$2,315.00                                 | \$482.45   | \$2,462.25  |
| Catalpa speciosa - Catalpa  | 5-15   | \$315.00            | \$4,725.00                      | \$438.00                                       | \$6,570.00                                 | \$453.80   | \$6,808.35  |
| Betula nigra - River Birch  | 10-20  | \$280.00            | \$5,600.00                      | \$347.00                                       | \$6,940.00                                 | \$437.83   | \$8,758.60  |
| Liriodendron tulipifera - Tuliptree   | 10-25  | \$315.00            | \$7,875.00                      | \$438.00                                       | \$10,950.00                                | \$460.32   | \$11,508.00 |
| Liquidambar styraciflua - Sweet Gum   | 0-5  | \$330.00            | \$1,650.00                      | \$438.00                                       | \$2,190.00                                 | \$508.52   | \$2,542.80  |
| Celtis occidentalis - Hackberry   | 10-20  | \$290.00            | \$5,800.00                      | \$438.00                                       | \$8,760.00                                 | \$444.25   | \$8,885.00  |
| Ginkgo biloba - Ginkgo  | 5-15   | \$360.00            | \$5,400.00                      | \$637.00                                       | \$9,555.00                                 | \$519.23   | \$7,788.45  |
| Ulmus 'Morton' - Accolade Elm   | 10-25  | \$305.00            | \$7,625.00                      | \$438.00                                       | \$10,950.00                                | \$485.88   | \$11,642.00 |
| Ulmus x 'Morton Glasy' - Triumph Elm  | 10-25  | \$305.00            | \$7,625.00                      | \$438.00                                       | \$10,950.00                                | \$480.32   | \$11,508.00 |
| Ulmus x 'Patriot' - Patriot Elm   | 10-20  | \$320.00            | \$6,400.00                      | \$438.00                                       | \$8,760.00                                 | \$440.81   | \$8,992.20  |
| Ulmus x 'Regal' - Regal Elm   | 10-20  | \$295.00            | \$5,900.00                      | \$438.00                                       | \$8,760.00                                 | NO BID     | \$0.00      |
| Carpinus Caroliniana - American Hornbeam  | 5-10   | \$360.00            | \$3,500.00                      | \$438.00                                       | \$4,380.00                                 | \$471.03   | \$4,710.30  |
| Cladrastis Kentuckea - Yellowwood   | 5-10   | \$350.00            | \$3,500.00                      | \$438.00                                       | \$4,380.00                                 | \$512.80   | \$5,128.00  |
| Taxodium distichum - Baldcypress  | 5-15   | \$275.00            | \$4,125.00                      | \$438.00                                       | \$6,570.00                                 | \$438.00   | \$6,583.50  |
| Aesculus flava - Yellow Buckeye   | 10-25  | \$275.00            | \$6,875.00                      | \$438.00                                       | \$10,950.00                                | \$478.80   | \$11,015.00 |
| Alnus glutinosa - Black Alder   | 0-10   | \$295.00            | \$2,950.00                      | \$438.00                                       | \$4,380.00                                 | \$438.00   | \$4,380.00  |
| <b>Total Bid</b>  |  |                     | \$159,035.00                    | \$228,110.00                                   | \$232,401.20                               |            |             |

STATE OF ILLINOIS  
VILLAGE OF HOFFMAN ESTATES  
2022 Parkway Tree Planting Program  
TABULATION OF BIDS

|  |  |                             |  |          |            |                                 |            |   |            |             |
|--|--|-----------------------------|--|----------|------------|---------------------------------|------------|---|------------|-------------|
| County: Cook   |  | Date: 1/30/2020             |  |          |            |                                 |            |   |            |             |
| Municipality or Road District: Hoffman Estates           |  | Time: 10:00 a.m.            |  |          |            |                                 |            |   |            |             |
| Section:   |  | Appropriation \$            |  | COMPANY  |            | St Aubin Nursery<br>Kirkland II |            | Bazry Landscape<br>Management<br>Des Plaines II |            |             |
| Estimate \$  |  | Attended by: Nick Lackowski |  |          |            |                                 |            | Apex Landscaping<br>Inc. Hawthorn Woods IL      |            |             |
| Proposal Guarantees:                                     |  |                             |  |          |            |                                 |            |   |            |             |
| 2022 Alternate Bid Season                                |  |                             |  |          |            |                                 |            |   |            |             |
| 2022 Proposed Cost:                                      |  | Ornamental Trees            |  | QUANTITY | Unit Price | Total                           | Unit Price | Total   | Unit Price | Total       |
| Acer lataricum - Tartarian Maple                         |  |                             |  | 5-10     | \$309.00   | 3,060.00                        | \$438.00   | \$4,380.00                                      | NO BID     | \$0.00      |
| Acer campestre - Hedge Maple                             |  |                             |  | 0-10     | \$299.00   | 2,990.00                        | \$438.00   | \$4,380.00                                      | \$465.68   | \$4,056.60  |
| Acer ginnala - Amur Maple Tree Form                      |  |                             |  | 0-10     | \$300.00   | 3,000.00                        | \$438.00   | \$4,380.00                                      | \$444.25   | \$4,442.50  |
| Amelanchier - Serviceberry Tree Form                     |  |                             |  | 5-15     | \$325.00   | 4,875.00                        | \$438.00   | \$8,570.00                                      | \$449.01   | \$8,744.15  |
| Cercis canadensis- Eastern Redbud                        |  |                             |  | 0-10     | \$335.00   | 3,350.00                        | \$438.00   | \$4,380.00                                      | \$462.41   | \$4,624.10  |
| Malus Species - Ornamental Crabapple 'Spring Snow'       |  |                             |  | 0-10     | \$300.00   | 3,000.00                        | \$268.00   | \$2,680.00                                      | \$401.41   | \$4,014.10  |
| Malus species - Ornamental Crabapple 'Red Baron'         |  |                             |  | 0-10     | \$300.00   | 3,000.00                        | \$268.00   | \$2,680.00                                      | NO BID     | \$0.00      |
| Malus Species - Ornamental Crabapple - 'Prairie Fire'    |  |                             |  | 0-10     | \$285.00   | 2,850.00                        | \$268.00   | \$2,680.00                                      | \$401.41   | \$4,014.10  |
| Crataegus Crus-Grill Inermis-Thornless Cocksaur Hawthorn |  |                             |  | 0-10     | \$330.00   | 3,300.00                        | \$268.00   | \$2,680.00                                      | \$432.47   | \$4,324.70  |
| Syringa reticulata - Japanese Tree Lilac 'Ivory Silk'    |  |                             |  | 15-25    | \$335.00   | 8,375.00                        | \$438.00   | \$10,950.00                                     | \$487.81   | \$12,445.25 |
| Magnolia acuminata - Cucumber Magnolia                   |  |                             |  | 5-10     | \$330.00   | 3,300.00                        | \$510.00   | \$8,100.00                                      | \$471.03   | \$4,710.30  |
| Total Bid  |  |                             |  |          |            | \$41,230.00                     |            | \$50,660.00                                     |            | \$49,876.00 |

STATE OF ILLINOIS  
 VILLAGE OF HOFFMAN ESTATES  
 2022 Parkway Tree Planting Program  
 TABULATION OF BIDS

|   |  |                             |  |          |                                 |  |  |              |            |              |
|---|--|-----------------------------|--|----------|---------------------------------|--|--|--------------|------------|--------------|
| County: Cook  |  | Date: 1/30/2020             |  | Company  | St Aubin Nursery<br>Kirkland IL | Bary Landscape<br>Management<br>Des Plaines IL | Apex Landscaping<br>Inc. Hawthorn Woods IL |              |            |              |
| Municipality or Road District: Hoffman Estates                            |  | Time: 10:00 a.m.            |  |          |                                 |  |  |              |            |              |
| Section:  |  | Appropriation \$            |  |          |                                 |  |  |              |            |              |
| Estimate \$   |  | Attended by: Nick Lackowski |  |          |                                 |  |  |              |            |              |
| Proposal Guarantee:   |  |                             |  |          |                                 |  |  |              |            |              |
| 2022 Alternate Bid Season   |  |                             |  |          |                                 |  |  |              |            |              |
| 2022 Proposed Cost:   |  | Evergreens & Shrubs         |  | QUANTITY | Unit Price                      | Total  | Unit Price                                 | Total        | Unit Price | Total        |
| Thuja occidentalis - Arborvitae 'Techny' or Pyramidal American            |  |                             |  | 0-10     | \$235.00                        | \$2,350.00                                     | \$185.00                                   | \$1,850.00   | \$369.53   | \$3,695.30   |
| Picea pungens - Colorado Blue Spruce 'Hoopsii'                            |  |                             |  | 0-3      | \$250.00                        | \$750.00                                       | \$439.00                                   | \$1,314.00   | \$530.20   | \$1,590.60   |
| Euonymus alatus - Burning Bush 'Rudy Haag' or 'True Dwarf'                |  |                             |  | 0-10     | \$35.00                         | \$350.00                                       | \$37.00                                    | \$370.00     | \$100.29   | \$1,002.90   |
| Spiraea japonica - Spiraea 'Shirobana' or 'Little Princess'               |  |                             |  | 0-6      | \$40.00                         | \$240.00                                       | \$44.00                                    | \$264.00     | \$103.23   | \$619.38     |
| Syringa meyeri - Dwarf Korean Lilac                                       |  |                             |  | 0-6      | \$45.00                         | \$270.00                                       | \$44.00                                    | \$264.00     | \$103.23   | \$619.38     |
| Syringa pubescens subsp. Patula - Dwarf Lilac 'Miss Kim'                  |  |                             |  | 0-10     | \$45.00                         | \$450.00                                       | \$44.00                                    | \$440.00     | \$103.23   | \$1,032.30   |
| Viburnum dentatum - Arrowwood Viburnum 'Autumn Jazz' or 'Chicago Lustare' |  |                             |  | 0-6      | \$45.00                         | \$270.00                                       | \$44.00                                    | \$264.00     | \$94.83    | \$568.98     |
| Taxus media - Japanese Yew (low growing variety)                          |  |                             |  | 0-15     | \$49.00                         | \$735.00                                       | \$69.00                                    | \$1,035.00   | \$124.12   | \$1,861.80   |
| Buxus microphylla - Boxwood 'Wintergreen' or 'Green Velvet'               |  |                             |  | 0-25     | \$60.00                         | \$1,500.00                                     | \$160.00                                   | \$3,750.00   | \$115.02   | \$2,675.50   |
| Ribes alpinum - Alpine Currant  |  |                             |  | 0-5      | \$45.00                         | \$225.00                                       | \$44.00                                    | \$220.00     | \$101.00   | \$505.45     |
| Cornus sericea - Dogwood 'Isanti' or 'Alleman's Compact'                  |  |                             |  | 0-5      | \$45.00                         | \$225.00                                       | \$44.00                                    | \$220.00     | \$97.34    | \$486.70     |
| Total Bid   |  |                             |  |          |                                 | \$7,365.00                                     |  | \$9,991.00   |            | \$14,658.69  |
| 2018 Cumulative Bid   |  |                             |  |          |                                 | \$207,630.00                                   |  | \$268,961.00 |            | \$297,226.00 |

VILLAGE OF HOFFMAN ESTATES  
2020 PARKWAY TREE PLANTING PROGRAM PROPOSAL

x St. Aubin Nursery & Lpg. Inc.  
Print Bid Firm Name Here

St. Aubin Nursery  
Print Material Source Supplier Here (Nursery)

It is understood that the Village of Hoffman Estates reserves the right to waive any formality in or to reject in whole or part, any bid, or all bids. Contractor's proposed costs for each plant specie indicated shall be based on the higher approximate quantity range needed to permit uniformity in bid proposal tabulations. It is understood by the Contractor that quantities indicated are an estimate only of the plantings to be installed each year and are listed for the comparison of bids and use in preparing annual budgets. Quantity ranges for species indicated may be exceeded for some species and be less than zero for other species when final list for ordering is completed. The Village reserves the right to change, add, and/or delete quantities of plant installations as it deems to be in its best interest. All bid prices shall remain firm for the entirety of said contract year and Contractor shall note that certain plant species indicated require utilization of indicated varieties and/or cultivars. The quantity of plantings to be installed each year is conditioned upon total funds budgeted for the program each year.

The undersigned having examined all bid documents for this bid call and having become familiar with the extent, nature, and local conditions affecting the cost and performance of the proposed work, hereby proposes to furnish all supervision, labor, tools, equipment, and materials necessary to perform and complete the work herein described at the following bid prices.

| 1. Shade Trees   |                                   |               | Alternate Bid Extension   | Alternate Bid Extension   |                           |
|--|-----------------------------------|---------------|---------------------------|---------------------------|---------------------------|
| Botanical/Common Name Variety/Cultivar   | Approximate Quantity Range Needed | Trunk Caliper | 2020 Proposed Cost (each) | 2021 Proposed Cost (each) | 2022 Proposed Cost (each) |
| Acer x freemanii - Freeman Maple 'Autumn Blaze'                                    | 15-25                             | 2 1/2"        | \$ 285-                   | \$ 290-                   | \$ 295-                   |
| Acer x freemanii - Freeman Maple 'Armstrong'                                       | 0-10                              | 2 1/2"        | \$ 295-                   | \$ 305-                   | \$ 315-                   |
| Acer miyabei - State Street Maple  | 15-25                             | 2 1/2"        | \$ 305-                   | \$ 318-                   | \$ 325-                   |
| Platanus x acerifolia - London Plane Tree  | 10-20                             | 2 1/2"        | \$ 319-                   | \$ 324-                   | \$ 329-                   |
| Carpinus caroliniana - American Hornbeam   | 10-20                             | 2 1/2"        | \$ 319-                   | \$ 319-                   | \$ 319-                   |
| Gleditsia triacanthos 'inermis' - Thornless Honeylocust 'Skyline' or 'Shademaster' | 15-25                             | 2 1/2"        | \$ 319-                   | \$ 319-                   | \$ 319-                   |
| Tilia cordata - Littleleaf Linden 'Glenleven' or 'Greenspire'                      | 10-20                             | 2 1/2"        | \$ 285-                   | \$ 290-                   | \$ 295-                   |
| Tilia Americana - American Linden  | 10-20                             | 2 1/2"        | \$ 290-                   | \$ 310-                   | \$ 310-                   |
| Tilia tomentosa - Silver Linden  | 10-20                             | 2 1/2"        | \$ 280-                   | \$ 290-                   | \$ 295-                   |
| Gymnocladus dioicus - Kentucky Coffeetree  | 5-15                              | 2 1/2"        | \$ 295-                   | \$ 305-                   | \$ 315-                   |

VENDOR NAME: St. Aubin Nursery & Lpg. Inc  
SIGNATURE: [Signature]

Availability subject to prior orders

| Botanical/Common Name<br>Variety/Cultivar  | Approximate<br>Quantity Range<br>Needed | Trunk<br>Caliper | 2020<br>Proposed<br>Cost (each) | Alternate Bid                                | Alternate Bid                                |
|--|---|------------------|---------------------------------|--|--|
|  |   |                  |                                 | Extension<br>2021<br>Proposed Cost<br>(each) | Extension<br>2022<br>Proposed Cost<br>(each) |
| Quercus bicolor –<br>Swamp White Oak       | 5-15                                    | 2 ½"             | \$ 300-                         | \$ 310-                                      | \$ 320-                                      |
| Quercus macrocarpa – Bur Oak               | 0-10                                    | 2 ½"             | \$ 270-                         | \$ 280-                                      | \$ 290-                                      |
| Quercus muehlenbergii –<br>Chinkapin Oak   | 5-15                                    | 2 ½"             | \$ 270-                         | \$ 290-                                      | \$ 310-                                      |
| Quercus imbricaria – Shingle Oak           | 0-10                                    | 2 ½"             | \$ 300-                         | \$ 310-                                      | \$ 320-                                      |
| Quercus rubra – Red Oak                    | 0-5                                     | 2 ½"             | \$ 310-                         | \$ 315-                                      | \$ 325-                                      |
| Catlapa speciosa – Catalpa                 | 5-15                                    | 2 ½"             | \$ 300-                         | \$ 315-                                      | \$ 315-                                      |
| Betula nigra - River Birch                 | 10-20                                   | 2 ½"             | \$ 270-                         | \$ 280-                                      | \$ 280-                                      |
| Liriodendron tulipifera – Tuliptree        | 10-25                                   | 2 ½"             | \$ 310-                         | \$ 315-                                      | \$ 315-                                      |
| Liquidambar styraciflua –<br>Sweet Gum     | 0-5                                     | 2 ½"             | \$ 320-                         | \$ 325-                                      | \$ 330-                                      |
| Celtis occidentalis – Hackberry            | 10-20                                   | 2 ½"             | \$ 270-                         | \$ 280-                                      | \$ 290-                                      |
| Ginkgo biloba – Ginkgo                     | 5-15                                    | 2 ½"             | \$ 340-                         | \$ 350-                                      | \$ 360-                                      |
| Ulmus x 'Morton' – Accolade Elm            | 10-25                                   | 2 ½"             | \$ 285-                         | \$ 295-                                      | \$ 305-                                      |
| Ulmus x 'Morton Glossy' –<br>Triumph Elm   | 10-25                                   | 2 ½"             | \$ 285-                         | \$ 295-                                      | \$ 305-                                      |
| Ulmus x 'Patriot' – Patriot Elm            | 10-20                                   | 2 ½"             | \$ 300-                         | \$ 310-                                      | \$ 320-                                      |
| Ulmus x 'Regal' – Regal Elm                | 10-20                                   | 2 ½"             | \$ 275-                         | \$ 285-                                      | \$ 295-                                      |
| Carpinus Caroliniana –<br>Amerian Hornbeam | 5-10                                    | 2 ½"             | \$ 330-                         | \$ 340-                                      | \$ 350-                                      |
| Cladrastis Kentuckea - Yellowwood          | 5-10                                    | 2 ½"             | \$ 330-                         | \$ 340-                                      | \$ 350-                                      |
| Taxodium distichum – Baldcypress           | 5-15                                    | 2 ½"             | \$ 250-                         | \$ 265-                                      | \$ 275-                                      |
| Aesculus flava – Yellow Buckeye            | 10-25                                   | 2 ½"             | \$ 250-                         | \$ 265-                                      | \$ 275-                                      |
| Alnus glutinosa – Black Alder              | 0-10                                    | 2 ½"             | \$ 290-                         | \$ 295-                                      | \$ 295-                                      |

VENDOR NAME:

St. Aubin Nursery & Log - Inc

SIGNATURE:

C. J. Aubin

Availability subject to prior orders

| 2. Ornamental Trees   |   |                  |                                 | Alternate Bid Extension         | Alternate Bid Extension         |
|---|---|------------------|---------------------------------|---------------------------------|---------------------------------|
| Botanical/Common Name<br>Variety/Cultivar                   | Approximate<br>Quantity Range<br>Needed | Trunk<br>Caliper | 2020<br>Proposed<br>Cost (each) | 2021<br>Proposed Cost<br>(each) | 2022<br>Proposed Cost<br>(each) |
| Acer tataricum - Tarturian Maple                            | 5-10                                    | 2 1/2"           | \$ 289-                         | \$ 299-                         | \$ 309-                         |
| Acer campestre - Hedge Maple                                | 0-10                                    | 2 1/2"           | \$ 260-                         | \$ 275-                         | \$ 299-                         |
| Acer ginnala - Amur Maple<br>Tree Form                      | 0-10                                    | 2 1/2"           | \$ 290-                         | \$ 290-                         | \$ 300-                         |
| Amelanchier - Serviceberry<br>Tree Form                     | 5-15                                    | 2 1/2"           | \$ 315-                         | \$ 325-                         | \$ 325-                         |
| Cercis canadensis - Eastern<br>Redbud                       | 0-10                                    | 2 1/2"           | \$ 315-                         | \$ 335-                         | \$ 335-                         |
| Malus Species- Ornamental<br>Crabapple 'Spring Snow'        | 0-10                                    | 2 1/2"           | \$ 300-                         | \$ 300-                         | \$ 300-                         |
| Malus Species - Ornamental<br>Crabapple 'Red Baron'         | 0-10                                    | 2 1/2"           | \$ 300-                         | \$ 300-                         | \$ 300-                         |
| Malus Species - Ornamental<br>Crabapple 'Prairie Fire'      | 0-10                                    | 2 1/2"           | \$ 295-                         | \$ 295-                         | \$ 295-                         |
| Crataegus crusgalli Inermis-<br>Thornless Cockspur Hawthorn | 0-10                                    | 2 1/2"           | \$ 320-                         | \$ 320-                         | \$ 330-                         |
| Syringa reticulata - Japanese Tree<br>Lilac 'Ivory Silk'    | 15-25                                   | 2 1/2"           | \$ 325-                         | \$ 325-                         | \$ 335-                         |
| Magnolia acuminata -<br>Cucumber Magnolia                   | 5-10                                    | 2 1/2"           | \$ 320-                         | \$ 320-                         | \$ 330-                         |

VENDOR NAME:

St. Aubin Nursery & Ldg., Inc.

SIGNATURE:

John

Availability subject to prior orders

| 3. Evergreens & Shrubs  |   |      |                                 | Alternate Bid Extension         | Alternate Bid Extension         |
|---|---|------|---------------------------------|---------------------------------|---------------------------------|
| Botanical/Common Name<br>Variety/Cultivar                           | Approximate<br>Quantity Range<br>Needed | Size | 2020<br>Proposed<br>Cost (each) | 2021<br>Proposed Cost<br>(each) | 2022<br>Proposed Cost<br>(each) |
| Thuja occidentalis – Arborvitae<br>'Techny' or 'Pyramidal American' | 0-10                                    | 6'   | \$ 225-                         | \$ 225-                         | \$ 235-                         |
| Picea pungens – Colorado Blue<br>Spruce 'Hoopsi'                    | 0-3                                     | 8'   | \$ 240-                         | \$ 240-                         | \$ 250-                         |
| Euonymus alatus – Burning Bush<br>'Rudy Haag' or 'True Dwarf'       | 0-10                                    | 12"  | \$ 35-                          | \$ 35-                          | \$ 35-                          |
| Spirea japonica – Spirea<br>'Shirobana' or 'Little Princess'        | 0-6                                     | 24"  | \$ 40-                          | \$ 40-                          | \$ 40-                          |
| Syringa meyeri –<br>Dwarf Korean Lilac                              | 0-6                                     | 24"  | \$ 45-                          | \$ 45-                          | \$ 45-                          |
| Syringa pubescens subsp. Patula –<br>Dwarf Lilac 'Miss Kim'         | 0-10                                    | 24"  | \$ 45-                          | \$ 45-                          | \$ 45-                          |
| Viburnum dentatum – Arrowwood<br>'Autumn Jazz' or 'Chicago Lusture' | 0-6                                     | 24"  | \$ 45-                          | \$ 45-                          | \$ 45-                          |
| Taxus media – Japanese Yew<br>Low growing variety                   | 0-15                                    | 24"  | \$ 49-                          | \$ 49-                          | \$ 49-                          |
| Buxus microphylla – Boxwood<br>'Wintergreen' or 'Green Velvet'      | 0-25                                    | 18"  | \$ 60-                          | \$ 60-                          | \$ 60-                          |
| Ribes alpinum – Alpine Currant                                      | 0-5                                     | 24"  | \$ 45-                          | \$ 45-                          | \$ 45-                          |
| Cornus sericea – Dogwood<br>'Isanti' or 'Alleman's Compact'         | 0-5                                     | 24"  | \$ 45-                          | \$ 45-                          | \$ 45-                          |

VENDOR NAME:

St. Aubin Nursery & Landscaping, Inc

SIGNATURE:

[Handwritten Signature]

Availability subject to prior orders



**COMMITTEE AGENDA ITEM  
VILLAGE OF HOFFMAN ESTATES**

**SUBJECT:** Request authorization to award contract for 2020 Contracted Parkway Tree Trimming Program to Advanced Tree Care, Lincolnshire, IL (low bid) in an amount not to exceed \$50,000.

**MEETING DATE:** February 24, 2020

**COMMITTEE:** Public Works & Utilities

**FROM:** Joseph Nebel, Director of Public Works  
Kelly Kerr, Assistant Director of Public Works  
Nick Lackowski, Village Forester

---

---

**PURPOSE:** To maintain proper visibility and safety for vehicular and pedestrian traffic, to promote health and vitality for disease resistance and attack from destructive insect pests, to regulate and encourage proper growth, reduce wind and snow/ice damage and to improve aesthetic characteristics to the overall tree canopy.

**BACKGROUND:** On January 22, 2020 the Village advertised for bids and sent bid documents to eight (8) vendors. These bids also sought options for 2<sup>nd</sup> and 3<sup>rd</sup> year contract extensions which saves staff time and allows vendors to bid on the potential of three years of tree work.

On February 5, 2020 five (5) bids were opened and staff began an evaluation process. After reviewing the bids it was determined that Advanced Tree Care, Lincolnshire, IL was the lowest responsible bidder. Advanced Tree care has performed tree trimming services for a number of municipalities including Schiller Park, Deerfield, Northbrook, and Highland Park. References were contacted and very positive feedback regarding the company's performance was received from all contacted. A comparison/tabulation of the five (5) bid proposals is attached.

**DISCUSSION:**

The 2020 budget includes funding for the use of (annual) contractor assisted tree trimming to augment the current in-house tree trimming program. This ongoing annual tree trimming program permits needed maintenance to occur on regularly scheduled intervals. It enables the timely removal of existing and potential hazardous conditions. In addition, the vendor work permits increased time and the ability for Village team members to address residents' requests for service.

It has been frequently noted that areas receiving scheduled recurring trimming, experience a dramatic decrease in resident requested in-house trimming operations as well as damage from wind and storms.

**FINANCIAL IMPACT:**

In 2020, a total of \$50,000 has been budgeted for contractor assisted tree trimming. The low qualifying bid received was in the amount of \$54,200 based on an *estimated quantity* of trees to be trimmed. This quantity was for the purpose of comparing bids only. The Village reserved the right to change, add or delete quantities of trees to be trimmed as it deems necessary. This was indicated in the bid specifications. Based on these specification requirements bidders submitted prices per tree to be trimmed by tree size class as indicated on the attached tabulation of bids form.

Given our ability to control the quantity of trees the contractor will trim, staff can cause the contract sum to be equal to that of the annual funding allocation.

The specifications mailed requesting bids from contractors for the performance of this work included an option, solely for the Village's future consideration, for extension of the contract for the respective 2021 and 2022 seasons. The value of potential contract extension, based upon vendor contract performance during the current season has been proven. The better care the successful contractor provides for the sites this year, in order that he attains VOHE's contract extension for the next season, the better the cumulative effect that this improved care level has upon VOHE properties.

**RECOMMENDATION:**

Request authorization to award contract for 2020 Contracted Parkway Tree Trimming Program to Advanced Tree Care, Lincolnshire, IL (low bid) in an amount not to exceed \$50,000.

**Note: Bid specifications and proposals in white binder in Trustee's Ante Room.**



x Advanced Tree Care Inc Date: 2/1/20

Return with Bid

Print Bid Firm Name Here

### Primary Bid – Parkway Tree Trimming 2020 Season

\*includes Contractor/Bidder hauling & disposal of tree debris at a legal disposal location as selected by Contractor/Bidder

| Description                 | Est. Qty. | Unit Price   | Total Price       |
|-----------------------------|-----------|--------------|-------------------|
| Size Class A (3" to 12")    | 450       | \$ <u>25</u> | \$ <u>11,250.</u> |
| Size Class B (12.1" to 18") | 500       | \$ <u>33</u> | \$ <u>16,500</u>  |
| Size Class C (18.1' to 24") | 300       | \$ <u>51</u> | \$ <u>15,300</u>  |
| Size Class D (24.1" to 30") | 150       | \$ <u>60</u> | \$ <u>9,000</u>   |
| Size Class E (30.1" to 36") | 15        | \$ <u>80</u> | \$ <u>1,200.</u>  |
| Size Class F (36" plus)     | 10        | \$ <u>95</u> | \$ <u>950</u>     |

2020 TOTAL COST FOR TREE TRIMMING \$ 54,200.

### Bid Extension – Parkway Tree Trimming 2021 Season

\*includes Contractor/Bidder hauling & disposal of tree debris at a legal disposal location as selected by Contractor/Bidder

| Description                 | Est. Qty. | Unit Price   | Total Price       |
|-----------------------------|-----------|--------------|-------------------|
| Size Class A (3" to 12")    | 400       | \$ <u>25</u> | \$ <u>10,000.</u> |
| Size Class B (12.1" to 18") | 450       | \$ <u>33</u> | \$ <u>14,850</u>  |
| Size Class C (18.1' to 24") | 450       | \$ <u>51</u> | \$ <u>22,950.</u> |
| Size Class D (24.1" to 30") | 150       | \$ <u>60</u> | \$ <u>9,000</u>   |
| Size Class E (30.1" to 36") | 15        | \$ <u>80</u> | \$ <u>1,200</u>   |
| Size Class F (36" plus)     | 10        | \$ <u>95</u> | \$ <u>950.</u>    |

2021 TOTAL COST FOR TREE TRIMMING \$ 58,950.

### Bid Extension – Parkway Tree Trimming 2022 Season

\*includes Contractor/Bidder hauling & disposal of tree debris at a legal disposal location as selected by Contractor/Bidder

| Description                 | Est. Qty. | Unit Price   | Total Price       |
|-----------------------------|-----------|--------------|-------------------|
| Size Class A (3" to 12")    | 300       | \$ <u>25</u> | \$ <u>7,500.</u>  |
| Size Class B (12.1" to 18") | 350       | \$ <u>33</u> | \$ <u>11,550.</u> |
| Size Class C (18.1' to 24") | 450       | \$ <u>51</u> | \$ <u>22,950.</u> |
| Size Class D (24.1" to 30") | 250       | \$ <u>60</u> | \$ <u>15,000.</u> |
| Size Class E (30.1" to 36") | 20        | \$ <u>80</u> | \$ <u>1,600.</u>  |
| Size Class F (36" plus)     | 20        | \$ <u>95</u> | \$ <u>1,900.</u>  |

2022 TOTAL COST FOR TREE TRIMMING \$ 60,500.

**COMMITTEE AGENDA ITEM  
VILLAGE OF HOFFMAN ESTATES**

**SUBJECT:** Request authorization to award contract for 2020 Contracted Branch/Brush Pickup Program to Lucas Landscape and Design of Deerfield, IL (low bid) in an amount not to exceed \$40,000.

**MEETING DATE:** February 24, 2020

**COMMITTEE:** Public Works & Utilities

**FROM:** Joseph Nebel, Director of Public Works  
Kelly Kerr, Asst. Director of Public Works  
Nick Lackowski, Village Forester

-----  
-----

**PURPOSE:** To award contract for 2020 Branch/Brush Pickup Program.

**BACKGROUND:** This is an annually budgeted program where the department provides a spring and fall brush pickup service to the residents of the village. The program is addressed through a combination of in-house staff as well as contractual assistance. This additional assistance has proven very beneficial to offsetting the need for additional public works staff from other divisions. This keeps department staff available to address regularly assigned duties or emergencies that may occur.

**DISCUSSION:** On January 29, 2020 five (5) bids were opened and staff began an evaluation process. After reviewing the bids it was determined that Lucas Landscape and Design, had submitted the lowest bid. Lucas Landscape and Design has provided storm damage clean up services utilizing grapple loaders for the Villages of Glenview, Wilmette and the City of Highland Park. All references were contacted and provided very positive feedback regarding the company's performance.

A comparison/tabulation of the five (5) bid proposals is attached.

**FINANCIAL IMPACT:**

The Village reserved the right to change, add or delete quantities of hours to be utilized. This quantity is conditioned upon the total amount of funds budgeted for the program each fiscal year as well as the amount of material that is set out for pick up.

Given our ability to control the quantity of hours the contractor will be utilized, staff can cause the contract sum to be equal to the available funding. Based on specification requirements, bidders submitted prices per hour for requested services as indicated on the attached tabulation form.

Funding for this year's program is supported by \$40,000, budgeted within the Street Division Forestry & Grounds Program. This represents an increase in funding for 2020 of \$10,000 that will be utilized to help offset some of the departmental burden for the spring season and allow favorable focus to be given to many of the programs that are performed throughout the spring.

Averages from data compiled from the last five years for the spring and fall programs are listed below:

| <b>Spring Program averages for the last five years</b> |                      |
|--|----------------------|
| Program Hours  | 700 Hours            |
| Total Pick ups   | 1450 Pick ups        |
| Total Yards  | 600 Yards generated  |
|  |                      |
| <b>Fall Program averages for the last five years</b>   |                      |
| Program Hours  | 1050 Hours           |
| Total Pick ups   | 2700 Pick ups        |
| Total Yards  | 1300 Yards generated |

A comparison of vendor bid pricing per hourly cost is as follows:

| <b>Bidder</b>                                      | <b>2020 Season</b> | <b>Alternate<br/>2021 Season</b> | <b>Alternate<br/>2022 Season</b> |
|--|--------------------|----------------------------------|----------------------------------|
| Lucas Landscape Design<br>Deerfield, IL            | \$240.00           | \$240.00                         | \$240.00                         |
| Kramer Tree Specialists Inc.<br>West Chicago, IL   | \$260.00           | \$265.20                         | \$265.20                         |
| Trees "R" Us Inc.<br>Wauconda, IL                  | \$300.00           | \$325.00                         | \$335.00                         |
| Winkler's Tree & Landscaping Inc.<br>La Grange, IL | \$415.00           | \$430.00                         | \$445.00                         |
| Steve Piper & Sons Inc.<br>Naperville, IL          | \$425.00           | \$437.75                         | \$450.80                         |

**RECOMMENDATION:**

Request authorization to award contract for 2020 Contracted Branch/Brush Pickup Program to Lucas Landscape Design of Deerfield, IL (low bid) in an amount not to exceed \$40,000.

**Note: Bid Specifications and individual bids are in the white binder in the Trustee's ante room.**

VILLAGE OF HOFFMAN ESTATES  
DEPARTMENT OF PUBLIC WORKS  
TABULATION OF BIDS FOR

Bid Opening Date: January 30, 2020  
Time: 10:00 AM  
Attended by: Nick Lackowski

Contracted Branch / Brush Pickup Program

| Firm:  | Lucas Landscape and design<br>Deerfield Il | Krammer Tree Specialists Inc.<br>West Chicago Il | Trees "R" Us, Inc<br>Wauconda Il | Winkler's Tree & Landscaping Inc.<br>La Grange Il | Steve Piper & Sons Inc.<br>Naperville Il |
|--|--|--|----------------------------------|---|--|
| Bid Deposit:                                       | Check                                      | Check  | Check                            | Check   | Check                                    |
| Amount of Deposit Received:                        | \$1,000.00                                 | \$1,000.00                                       | \$1,000.00                       | \$1,000.00  | \$1,000.00                               |
| Bid Certification Form Notarized:                  | Yes  | Yes  | Yes                              | Yes   | Yes                                      |
| Substance Abuse Prevention Certificate:            | Yes  | Yes  | Yes                              | Yes   | Yes                                      |
| References Provided:                               | Yes  | Yes  | Yes                              | Yes   | Yes                                      |
| Items  |  |  |                                  |   |  |
| 2017 Season Cost Per Hour Equipment And Personnel  | \$240.00                                   | \$260.00   | \$300.00                         | \$415.00  | \$425.00                                 |
| *2018 Season Cost Per Hour Equipment And Personnel | \$240.00                                   | \$285.20   | \$325.00                         | \$430.00  | \$437.75                                 |
| *2019 Season Cost Per Hour Equipment And Personnel | \$240.00                                   | \$285.20   | \$335.00                         | \$445.00  | \$450.80                                 |
| <b>Total Bid</b>                                   | <b>\$720.00</b>                            | <b>\$790.40</b>                                  | <b>\$960.00</b>                  | <b>\$1,290.00</b>                                 | <b>\$1,313.55</b>                        |

\* Indicates possible bid extention



**Bidder's Please Note**

**Contractors shall perform this operation by way of loading of branch/brush piles utilizing a grapple or prentice loader type equipment and hauling out loads on trucks.**

**Primary Bid – Contracted Branch/Brush Pickup Program- 2020 Season**

\*includes Contractor pickup, hauling & disposal of tree debris at a legal disposal location as provided by the Village. Debris may be transported to the processing yard location in the form of branches and brush as long as loads are secured in a safe and secure method to avoid the debris loss, spilling or blowing of material from the equipment utilized to move the material.

2020 Cost per hour for grapple style truck loader with operator,  
haul truck(s) & operator(s) & ground man(if necessary)

2020 Cost /Hour \$ 240.00

**Bid Extension – Contracted Branch/Brush Pickup Program- 2021 & 2022 Seasons**

\*includes Contractor performance of identical services as primary bid for additional seasons of 2021 & 2022

2021 Cost per hour for grapple style truck loader with operator,  
haul truck(s) & operator(s) & ground man(if necessary)

2021 Cost /Hour \$ 240.00

2022 Cost per hour for grapple style truck loader with operator,  
haul truck(s) & operator(s) & ground man(if necessary)

2022 Cost /Hour \$ 240.00

**Site provided by the Village for disposal of material is Midwest Material Management LLC, 566 Rock Road, East Dundee, IL, 60118 whose yard is located at the Beverly Gravel & Materials Yard located on the south side of Rt 72 just west of Beverly Road.**

**Note: Costs for disposal of materials disposed of at an alternative locations not listed above will be borne to the contractor.**

**COMMITTEE AGENDA ITEM  
VILLAGE OF HOFFMAN ESTATES**

**SUBJECT:** Request authorization to waive bidding and purchase replacement Transportation and Engineering Division vehicle Unit E98 through the Northwest Municipal Conference Suburban Purchasing Cooperative from Currie Motors, Frankfort, IL, in an amount not to exceed \$27,676.

**MEETING DATE:** February 24, 2020

**COMMITTEE:** Public Works and Utilities

**FROM:** Alan Wenderski / Ryan Johnson

**PURPOSE:** Request authorization to waive bidding and purchase replacement Transportation and Engineering Division vehicle Unit E98 through the NWMC Suburban Purchasing Cooperative from Currie Motors, Frankfort, IL, in an amount not to exceed \$27,676.

**BACKGROUND:** The approved 2020 budget included the replacement of the current Transportation and Engineering vehicle E98 (2008 Ford Escape Hybrid) at a cost of \$30,000.

**DISCUSSION:** Current Unit E98 is a 2008 Ford Escape Hybrid with approximately 99,000 miles. The requested replacement vehicle is a 2020 Ford Escape SE FHEV (Hybrid). The cost of the new vehicle is \$27,676 with an additional \$2,000 required to install a light bar and strobe lights for safety. The purchase and installation of the light bar and strobe lights will be completed by Public Works. The total cost of the vehicle, with light bar and strobe lights, will not exceed \$29,676, which is under the \$30,000 budget amount.

**FINANCIAL IMPACT:** The purchase price falls within the budgeted amount and capital funds are available.

**RECOMMENDATION:** Request authorization to waive bidding and purchase replacement Transportation and Engineering Division vehicle Unit E98 through the Northwest Municipal Conference Suburban Purchasing Cooperative from Currie Motors, Frankfort, IL, in an amount not to exceed \$27,676.

Attachment



**2020 Ford Escape S Front Wheel Drive  
Contract# 165**



Currie Motors Fleet

**“Nice People to Do Business With”**

Visit our new website

[www.curriecommercial.com](http://www.curriecommercial.com)

Order Cut- Off: TBD

Contract # 165

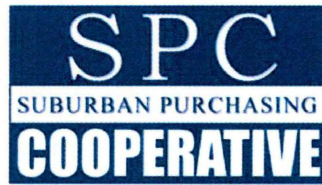

**Currie Motors Frankfort**

**SPC Contract Winner**

**2020 Ford Escape S Front Wheel Drive**

**Contract #165**

**Call Tom Sullivan (815) 464-9200**

**Standard Package: 20,885.00**

**Warranty: 3 Years 36, 000 miles Bumper to Bumper/ 5 Years 60,000 Power train**

Free Delivery within 50 Miles  
Climate Control  
Advance Trac w/RSC  
Power Windows Power Locks  
Remote Keyless-Flip Key  
Side View Mirrors-Power Glass  
AM/FM/CD- SYNC  
Variable Intermittent- Wipers  
Rear Defroster  
Electric Power Assist Steering  
Cruise Control  
Ford Pass Connect-4G LTE Wi-Fi  
Personal Safety System  
17" Steel Wheels  
6-Way Manual Adjust Drivers Seat  
Cloth Front Bucket Seats  
60/40Split-Fold-Flat Rear Seats  
Rotary Gear Shift Dial  
Center Console w/Armrest

Front Carpeted Floor Mats  
Anti-Lock Brakes-w/Post  
Collision Braking  
Frt/Rr Stabilizer Bar  
Halogen Headlamps  
Solar Tinted Glass  
Battery Saver Feature  
Message Center  
Sun Visors w/Dual Mirrors  
Tilt and Telescoping Wheel  
1.5L Eco boost w/ Auto Start-Stop  
Technology  
8-Speed Automatic Transmission  
Body Color Rear Spoiler  
SecuriLock Passive Anti-Theft  
Tire Pressure Monitoring System  
3-Power Points  
Mini Spare Tire  
Rear View Camera

**Available Models**

|                                     |                                |           |
|-------------------------------------|--------------------------------|-----------|
| <input type="checkbox"/>            | Escape SE All Wheel Drive      | 23,986.00 |
| <input checked="" type="checkbox"/> | Escape SE FHEV All Wheel Drive | 26,715.00 |

**Options**

|                                     |   |         |
|-------------------------------------|---|---------|
| <input checked="" type="checkbox"/> | Cargo Mat                                   | 86.00   |
| <input type="checkbox"/>            | Block Heater                                | 33.00   |
| <input checked="" type="checkbox"/> | Day Time Running Lights                     | 42.00   |
| <input checked="" type="checkbox"/> | Floor Liners                                | 119.00  |
| <input checked="" type="checkbox"/> | Privacy Glass                               | 261.00  |
| <input type="checkbox"/>            | Reverse Sensing System                      | 232.00  |
| <input type="checkbox"/>            | Easy Access Cargo Shade                     | 128.00  |
| <input type="checkbox"/>            | Rustproofing (Sound Shield N/A)             | 295.00  |
| <input type="checkbox"/>            | 17" Shadow Silver-painted Aluminum Wheels   | 565.00  |
| <input type="checkbox"/>            | Wheel Locking Lug Nuts                      | 71.00   |
| <input type="checkbox"/>            | Cargo Management System-S model only        | 375.00  |
| <input type="checkbox"/>            | Remote Start-late availability              | 470.00  |
| <input type="checkbox"/>            | Splash Guards-late availability             | 199.00  |
| <input type="checkbox"/>            | CD Rom Shop Manual                          | 295.00  |
| <input type="checkbox"/>            | 3 year/100000 Mile Powertrain Care Warranty | 1195.00 |
| <input type="checkbox"/>            | 5 year/60,000 Mile Base Care Warranty       | 1395.00 |
| <input type="checkbox"/>            | Delivery >50 miles                          | 165.00  |
| <input checked="" type="checkbox"/> | Municipal Plates M___MP____ (Shipped)       | 203.00  |
| X                                   | Additional key                              | 250.00  |

**Exterior Colors**

|                                     |                                  |        |
|-------------------------------------|----------------------------------|--------|
| <input type="checkbox"/>            | Star White Metallic Tri Coat-SE  | 565.00 |
| <input type="checkbox"/>            | Sedona Orange Metallic           | N/C    |
| <input type="checkbox"/>            | Rapid Red Metallic Clear Coat-SE | 375.00 |
| <input type="checkbox"/>            | Dark Persian Green Metallic      | N/C    |
| <input type="checkbox"/>            | Velocity Blue Metallic           | N/C    |
| <input type="checkbox"/>            | Desert Gold Metallic             | N/C    |
| <input type="checkbox"/>            | Magnetic                         | N/C    |
| <input type="checkbox"/>            | Agate Black                      | N/C    |
| <input checked="" type="checkbox"/> | Oxford White                     | N/C    |
| <input type="checkbox"/>            | Ingot Silver Metallic            | N/C    |

**Interior Colors**

|                                     |                           |     |
|-------------------------------------|---------------------------|-----|
| <input type="checkbox"/>            | Ebony                     | N/C |
| <input checked="" type="checkbox"/> | Ebony/Sandstone – SE Only | N/C |

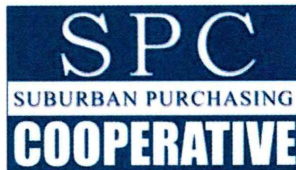

|                                    |   |
|------------------------------------|---|
| <b>Title Name</b>                  | Village of Hoffman Estates                      |
| <b>Title Address</b>               | 1900 Hassell Road                               |
| <b>Title City</b>                  | Hoffman Estates                                 |
| <b>Title Zip Code</b>              | 60169   |
| <b>Contact Name</b>                | Ryan Johnson                                    |
| <b>Phone Number</b>                | (847) 781-2669                                  |
| <b>Purchase Order Number</b>       | ...   |
| <b>Fleet Identification Number</b> | E98   |
| <b>Tax Exempt Number</b>           |   |
| <b>Total Dollar Amount</b>         | \$27,676  |
| <b>Total Number of Units</b>       | 1   |
| <b>Delivery Address</b>            | 2405 Pembroke Ave.<br>Hoffman Estates, IL 60169 |

**\*Orders Require Signed Original Purchase Order and Tax Exempt Letter Submitted to:**

*Currie Motors Fleet  
10125W Laraway  
Frankfort, IL 60423  
PHONE: (815)464-9200  
Tom Sullivan [Curriefleet@gmail.com](mailto:Curriefleet@gmail.com)  
Kristen De La Riva [Fleetcurrie@gmail.com](mailto:Fleetcurrie@gmail.com)*

***\*Fleet Status is accessible by registering at [www.fleet.ford.com](http://www.fleet.ford.com). Please provide FIN Code at time of order to track your order times. Lead times are 12-14 weeks.***

***\*Title Corrections will be Billed Appropriate Assessed Fees by the Sec. of State***

Contract #165

**COMMITTEE AGENDA ITEM  
VILLAGE OF HOFFMAN ESTATES**

**SUBJECT:** Discussion regarding and authorization to:

- a) selection of a sign design and color for an electronic message board and entryway sign; and
- b) waive bidding and award contract for the installation of an electronic message board and entryway sign at the Village Hall to Quantum Sign Corp., Sugar Grove, IL in an amount not to exceed \$52,730.

**MEETING DATE:** February 24, 2020

**COMMITTEE:** Public Works & Utilities

**FROM:** Joseph Nebel, Director of Public Works  
John Kovaka, Traffic Operations Supervisor

---

---

**PURPOSE:** To update and relocate the entrance sign at the Village Hall, 1900 Hassell Road, with an electronic message board to be located at the northwest corner of the entrance. In addition to replacing the entrance sign, add a new low profile monument sign to the entrance island.

**BACKGROUND:** The current entrance sign at the Village Hall is in poor condition, and not in a good location to identify the property as the Village Hall.

**DISCUSSION:** As a result of efforts to update the aged and antiquated entryway sign, two separate sign contractors were asked to submit design proposals for the entrance to the Village Hall. The proposals were to include design options for a Watchfire electronic message board that was compatible with other Village signs, installed at the northwest corner of the entrance to the Village Hall, and a matching low profile monument sign to be installed in the center island at the entrance to the Village Hall parking lot. Quantum Sign Corp of Sugar Grove, IL, who recently worked with Kevin Kramer and Economic Development, submitted several favorable design options.

A concern that rose was the potential for light pollution to affect the residents in the townhouses on Hassell near the entrance to the Village Hall. It is hoped the impact will be negligible with the placement of the sign focused on the intersection of Hassell and

**DISCUSSION: (continued)**

Huntington, rather than directly facing the buildings. The ability to dim the message board in the evenings as needed should also reduce the impact.

**FINANCIAL IMPACT:**

Quantum Sign Corp quoted a price of \$36,846 for the fabrication and installation of a single-faced monument sign with electronic message board, to be located at the northwest corner of the entrance to the Village Hall. Quantum Sign Corp also quoted a price of \$15,884 for the fabrication and installation of a double-faced monument sign in the center island of the entrance to the Village Hall. The total quote for the both signs from Quantum Signs is \$52,730. There was \$125,000 approved in the 2019 Mid-year financial review which remains available for replacement of the existing sign.

**RECOMMENDATION:**

Discussion regarding and authorization to:

- a) selection of a sign design and color for an electronic message board and entryway sign; and
- b) waive bidding and award contract for the installation of an electronic message board and entryway sign at the Village Hall to Quantum Sign Corp., Sugar Grove, IL in an amount not to exceed \$52,730.

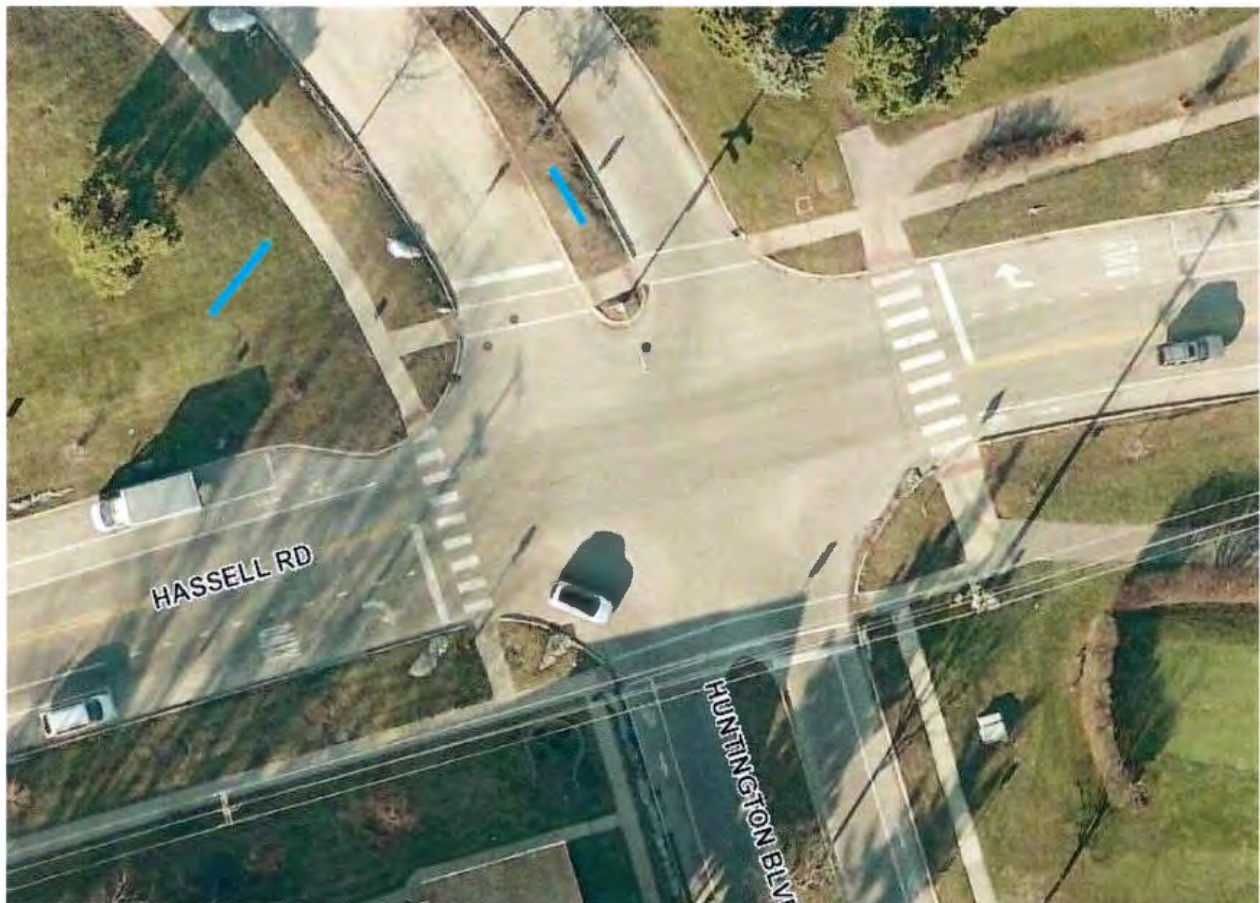



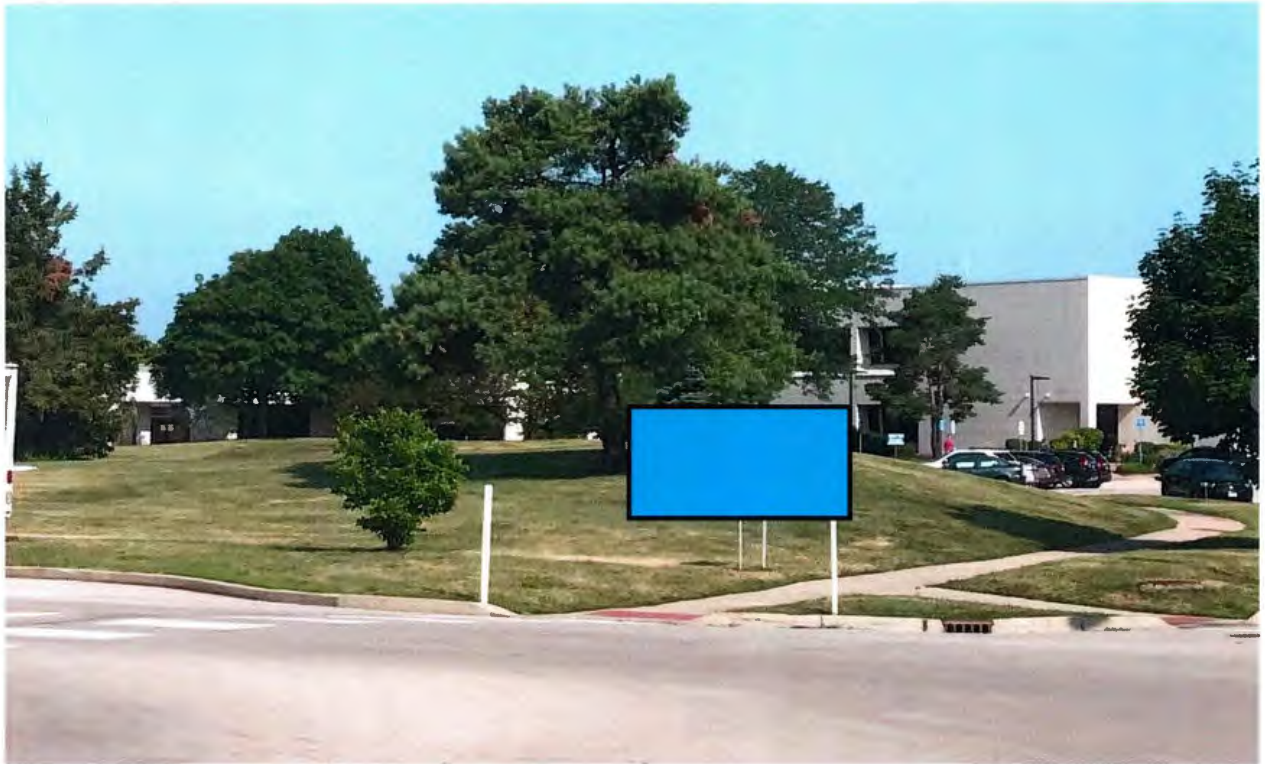



# **Village Hall Sign Replacement**

**DESIGN SELECTION**

## Existing Sign



The existing Village Hall sign was installed before the Village purchased the building. The Hoffman Estates nameplate was added ~1991. The internal lighting was upgraded to LEDs ~2008.

# Proposed Sign Locations

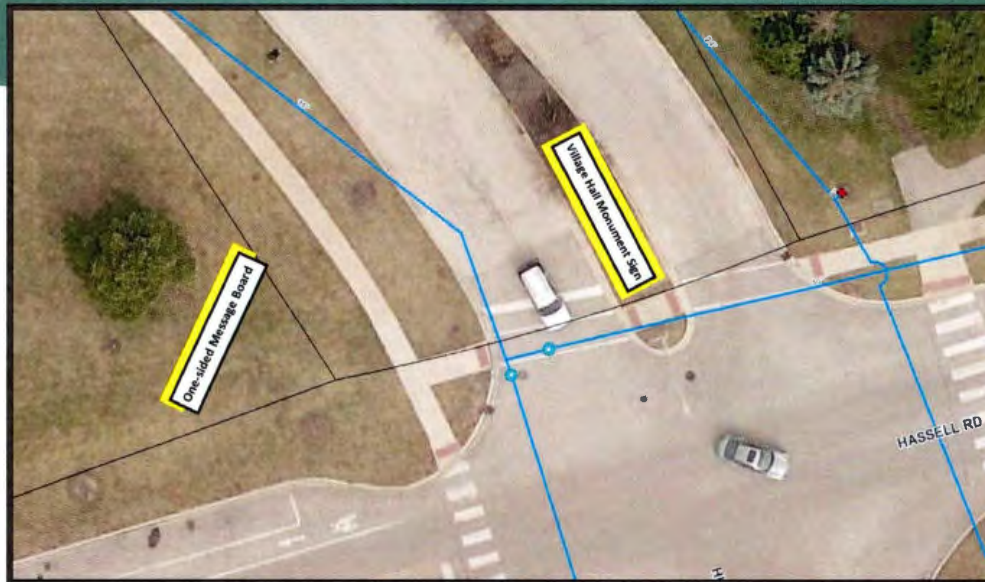

The current proposal is for two new Village Hall signs: one single-sided message board near the site of the existing sign and one monument sign in the center-island.

# Rendering 1: Saddle

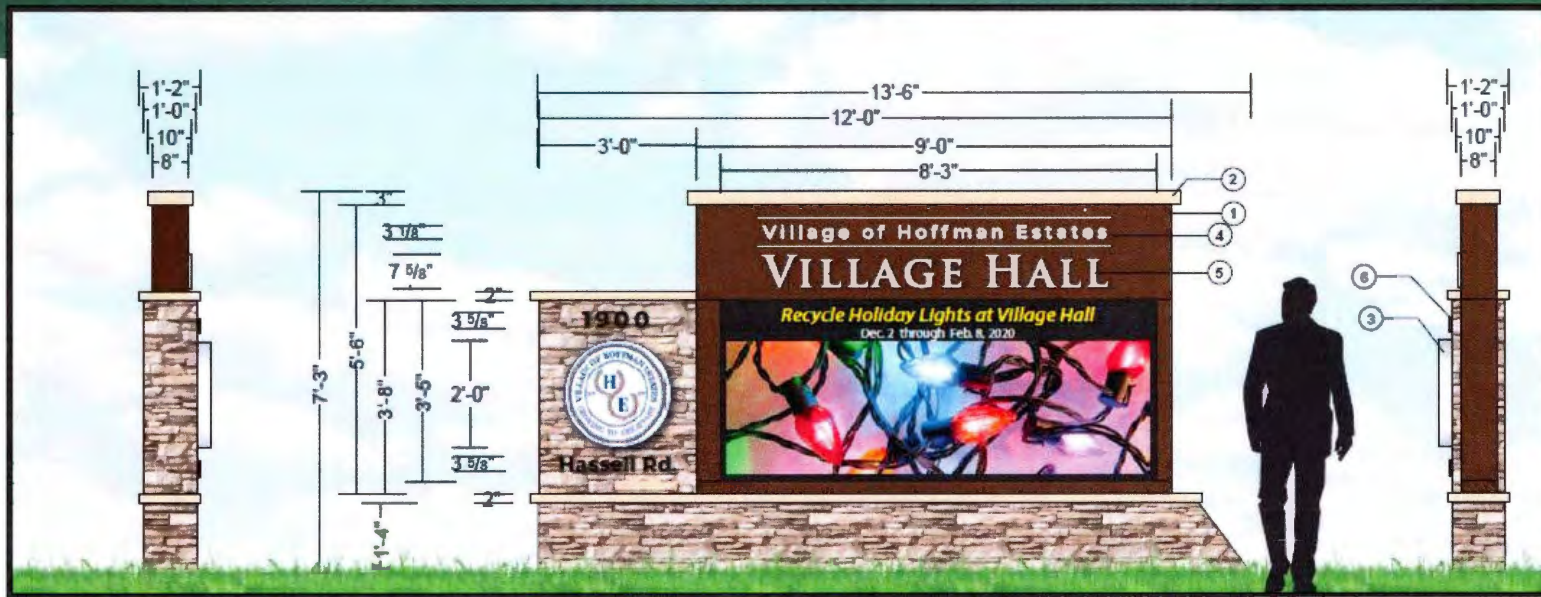

Proposed single-sided message board (above) and monument sign (right) in color combo "Saddle".



# Rendering 2: Pewter

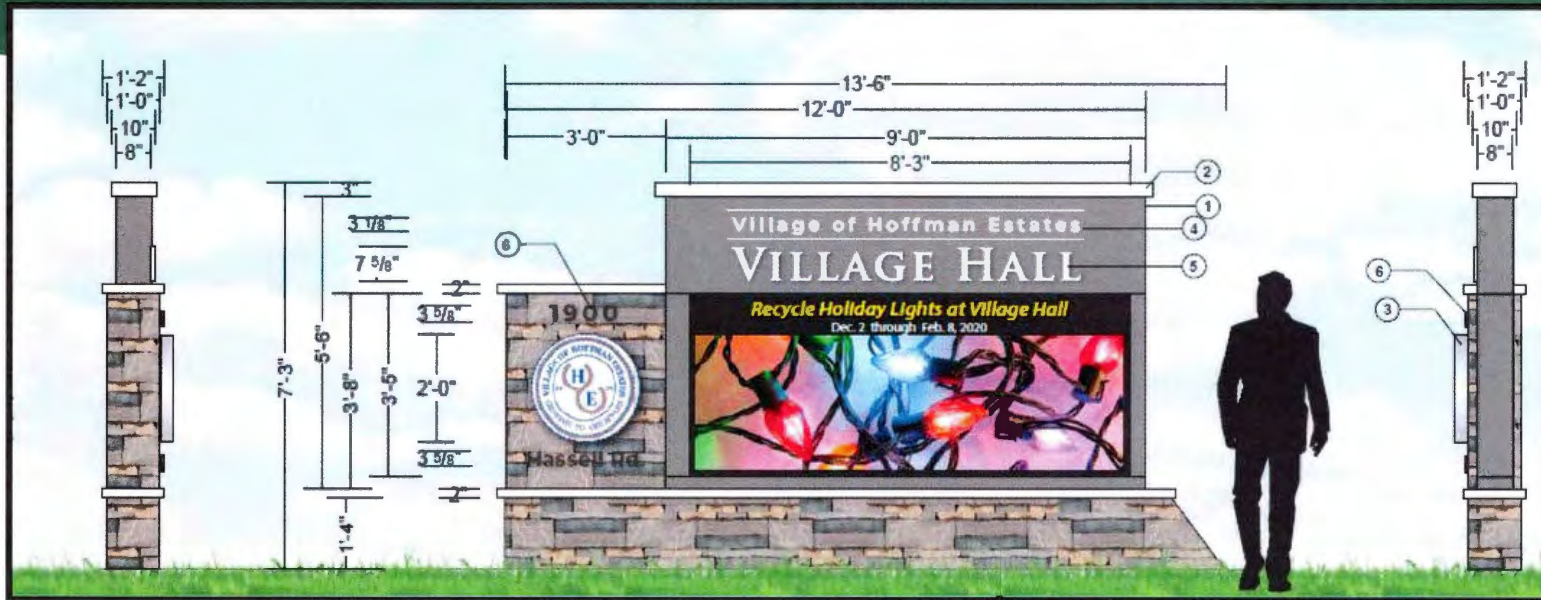

Proposed single-sided message board (above) and monument sign (right) in color combo "Pewter".



# Rendering 3: Dune

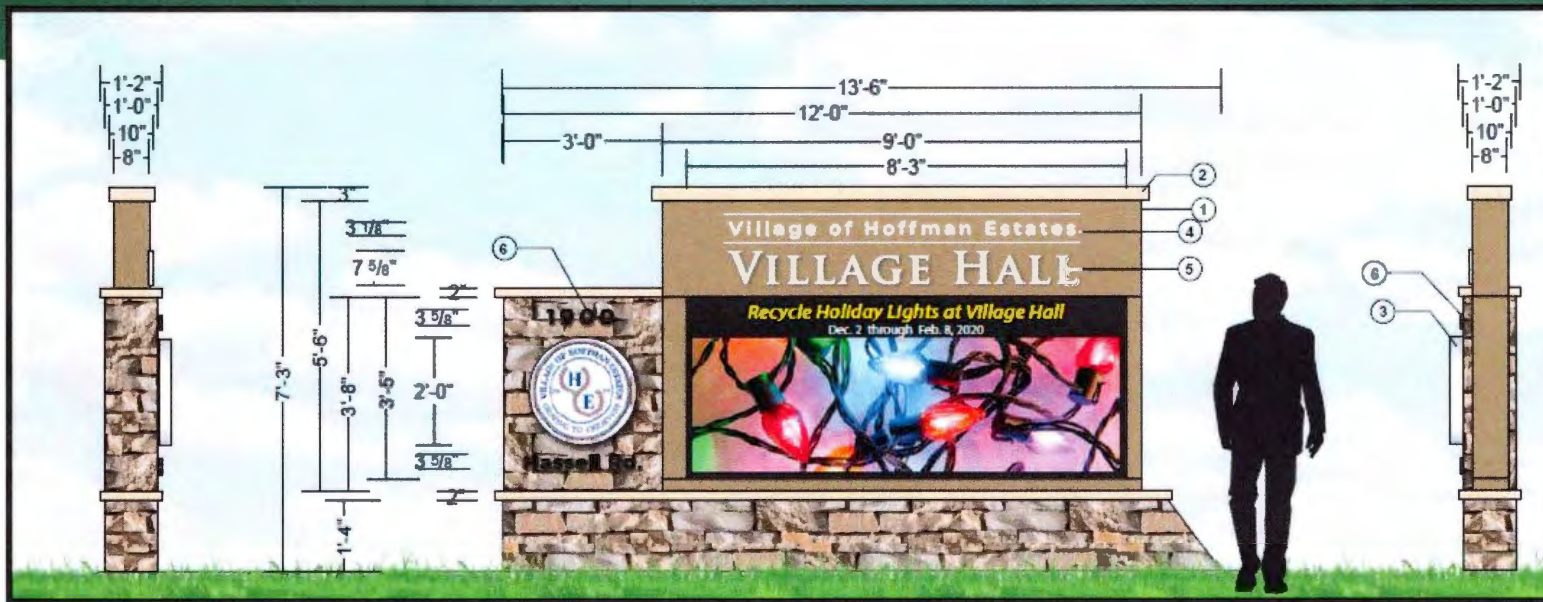

Proposed single-sided message board (above) and monument sign (left) in color combo "Dune".



# Rendering 4: Steel Wool

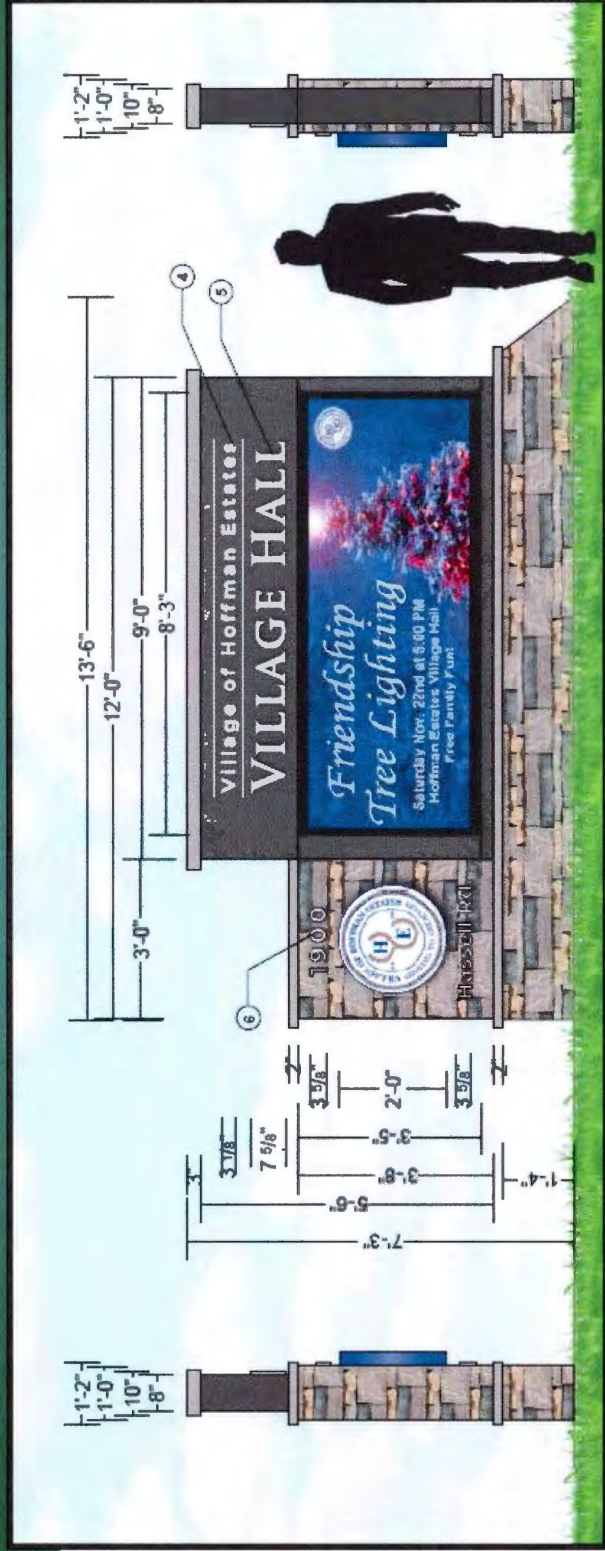

Proposed single-sided message board (above) and monument sign (right) in color combo "Steel Wool".



# Rendering 5: Maple



Proposed single-sided message board (above) and monument sign (right) in color combo "Maple".

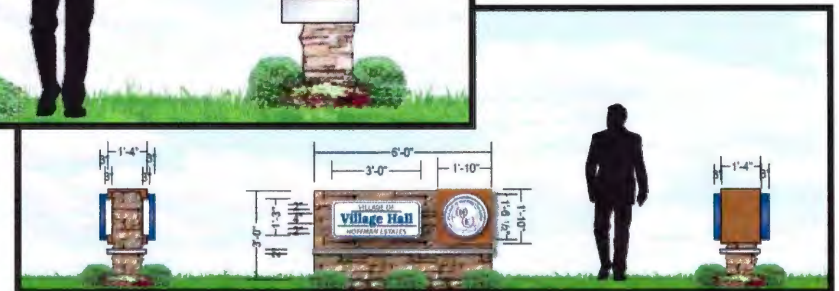

# Rendering 6: Stonewall

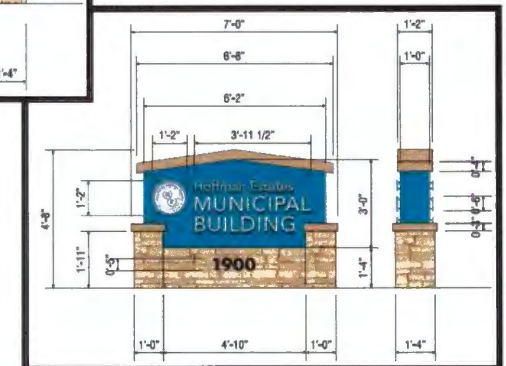
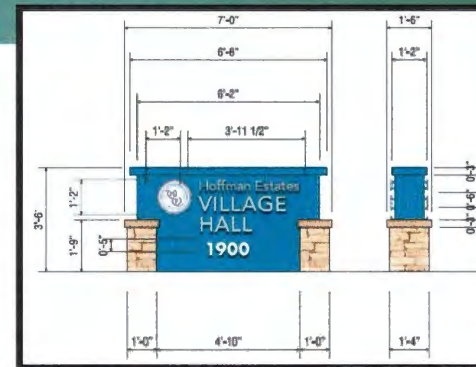
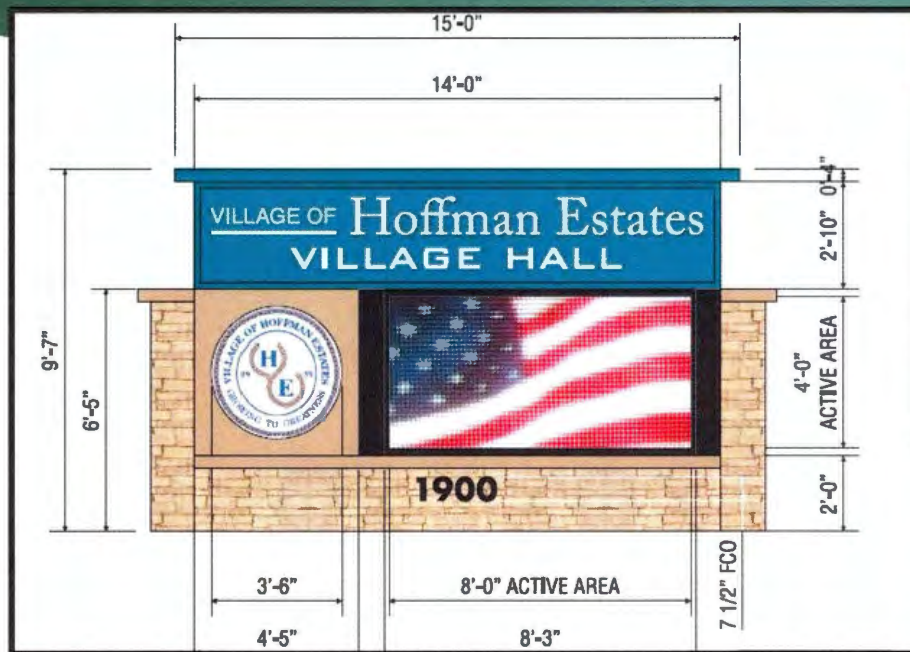

Proposed single-sided message board (left) and monument sign options (right) in color combo "Stonewall".

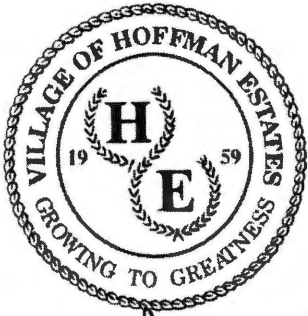

# VILLAGE OF HOFFMAN ESTATES

## DEPARTMENT OF PUBLIC WORKS

### January 2020 MONTHLY REPORT

SUBMITTED TO: Public Works Committee

February 2020

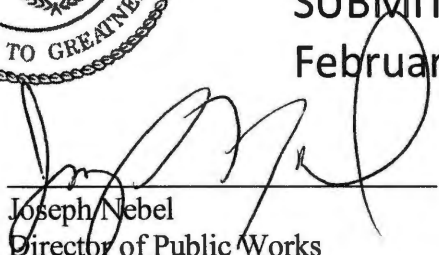
  
Joseph Nebel  
Director of Public Works

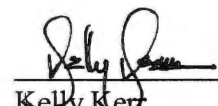
  
Kelly Kerr  
Assistant Director of Public Works

---

## MAJOR PROJECT STATUS

### Well 9 Abandonment

On August 19, 2019 Village Board authorized the contract with Water Well Solutions for the work to properly abandon Well 9. Pre-Construction Meeting was held shortly. Permit application has been submitted to Cook County Public Health Department (PHD). The plan for well abandonment was revised per County instruction and was resubmitted to the County PHD. The work started in the week of September 23. By the end of September the well pump and column piping has been all removed. By the end of October the project is complete for all work on Well 9 abandonment. Everything is satisfactory to the County Department of Public Health. The completed well sealing forms were submitted to IEPA. Final invoice, including Change Order, has been approved. **In January 2020, with limited contractor assistance, the following work is all complete, which includes:**

1. Demolition of structure down to top of slab-
2. Removal of concrete footings and foundations
3. Site asphalt removals throughout the lot
4. Removal of water main and sewer service pipes

The remaining work is removal of water main connection and the tap/Tee, which is planned in coordination of the street reconstruction project. In addition, with assistance from the contractor, the deficiency of the overfilled concrete and casing pipe will be removed.

### Water Distribution Systems Study

On April 1, 2019 Village Board authorized the contract with Burns & McDonnell for engineering services to study & evaluate the Village's water distribution systems for infrastructure capital project planning. Project Kick-Off Meeting was held on May 14, 2019. Due to the long time needed for massive amount data collection and processing on Village's water distribution system, field work did not start until September. Work completed in September includes loading Historian program into the SCADA system for comprehensive analysis of water system operation and Laying out field work for fire flow testing and telog installation. Hydraulic model for the water system is being created. Work completed in October includes:

field measurements (fire flows & pressures) and field data insertion into the model, model calibration. Work completed in November includes tower evaluation as well as running scenarios to confirm model results in comparison to SCADA system data. **Work completed in January includes:**

**Completion of system analysis with brief summary of results.**

## **Completion of preliminary Aster Lane tower and station evaluation and overall storage analysis.**

Work planned for February:

1. Work session on model for hydraulic analysis and storage analysis (2/25) to review analysis results and project usage
2. Complete system improvement analysis and initiate develop capital improvement plan.
3. Initiate the Water Main Replacement Task.

### **MWRD IICP Engineering**

On July 2, 2018 the Village Board approved a contract with Baxter & Woodman Consulting Engineers for engineering and field services required for compliance with MWRD' Infiltration/Inflow Control Program (IICP). The services will cover the following areas:

1. Conduct a prioritized condition assessment of high risk public sanitary sewer system infrastructure through various inspection and testing methods.
2. Begin rehabilitation of major defects within three years of identification.
3. Utilize inspections to catalog illegal connections in high risk areas for disconnection in Private Sector Program (PSP).
4. Develop and implement a Private Sector Program (PSP).
5. Develop and submit annual reports under the Short Term Requirements and Long Term Operation and Maintenance Program (LTOMP)

Project Kick off meeting was held on August 8, 2018 with planning of the immediate task of smoke testing of all sanitary sewer in high risk areas, which was completed in October, 2018 and covered all High Risk Areas (12 sub-basins with a total of 133,133 feet of sewer mains) per MWRD standards. Review of the final report is completed and 4 areas have been identified for dye water testing to further determine point of source of infiltration and inflow into the sanitary sewer system. The actual work of dye water testing was completed in June. Camera inspection of remaining 173 manholes inspection is in May 2019. A list of critical sewer repairs has been selected for IICP compliance in 2019 and 2020. Design engineering and preparation of bid documents was completed in September 2019. The project was bid out successfully and contract was awarded to the low responsible bidder, Michels Pipe Services. Construction contract was executed. Pre-construction meeting was held on December 12, 2019. Work planning is all complete. **Sewer cleaning and inspection is all complete in January 2020 and sewer rehab by cured-in-place pipe (CIPP) lining is scheduled for late February and March 2020. Staff already responded to comments by MWRD on the Village's Private Sector Program (PSP) and the Long Term Operation and Maintenance Program (LTOMP). Staff consider both PSP and LTOMP accepted.**

## Customer Services

### Fast Action Service Team (FAST):

1. Continued salt dome roller replacement project.

| Fast Action Service Team (FAST) |     |     |     |     |     |     |     |     |     |     |     |       |
|---------------------------------|-----|-----|-----|-----|-----|-----|-----|-----|-----|-----|-----|-------|
| Customer Service Requests       |     |     |     |     |     |     |     |     |     |     |     |       |
| Jan                             | Feb | Mar | Apr | May | Jun | Jul | Aug | Sep | Oct | Nov | Dec | Total |
| 159                             |     |     |     |     |     |     |     |     |     |     |     | 159   |

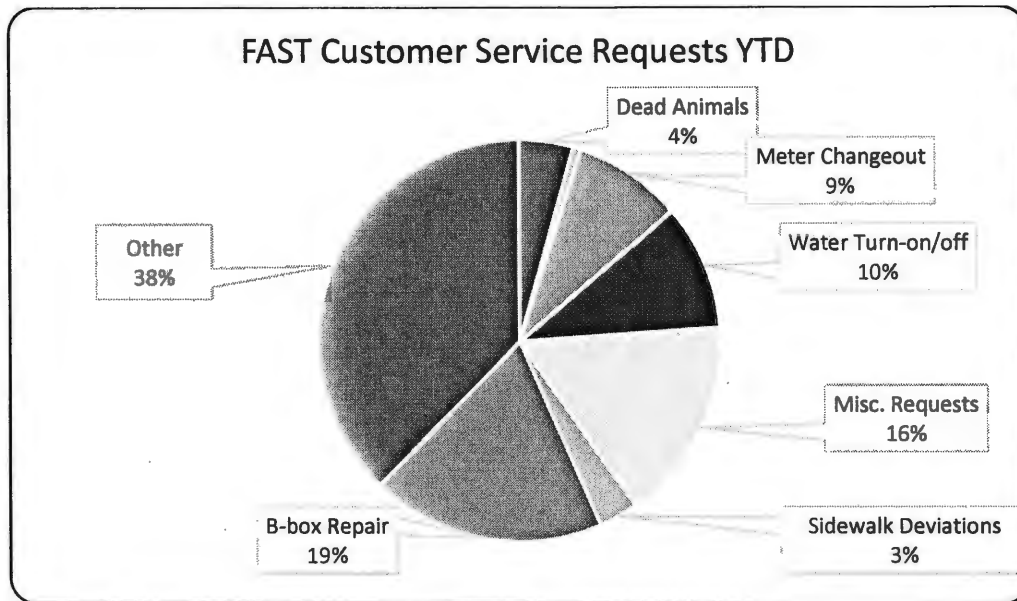

### Customer Service Team:

| Customer Service Team                             |     |     |     |     |     |     |     |     |     |     |     |       |
|---|-----|-----|-----|-----|-----|-----|-----|-----|-----|-----|-----|-------|
| Water Billing - Customer Service Appointments     |     |     |     |     |     |     |     |     |     |     |     |       |
| Jan   | Feb | Mar | Apr | May | Jun | Jul | Aug | Sep | Oct | Nov | Dec | Total |
| 53  |     |     |     |     |     |     |     |     |     |     |     | 53    |
| Finance-generated Water Meter Readings            |     |     |     |     |     |     |     |     |     |     |     |       |
| Jan   | Feb | Mar | Apr | May | Jun | Jul | Aug | Sep | Oct | Nov | Dec | Total |
| 246   |     |     |     |     |     |     |     |     |     |     |     | 246   |
| Delinquent Water Accounts                         |     |     |     |     |     |     |     |     |     |     |     |       |
| Jan   | Feb | Mar | Apr | May | Jun | Jul | Aug | Sep | Oct | Nov | Dec | Total |
| 91  |     |     |     |     |     |     |     |     |     |     |     | 91    |
| New Construction Inspections                      |     |     |     |     |     |     |     |     |     |     |     |       |
| Jan   | Feb | Mar | Apr | May | Jun | Jul | Aug | Sep | Oct | Nov | Dec | Total |
| 4   |     |     |     |     |     |     |     |     |     |     |     | 4     |
| Customer Service Requests - Gov Q&A/Meter Repairs |     |     |     |     |     |     |     |     |     |     |     |       |
| Jan   | Feb | Mar | Apr | May | Jun | Jul | Aug | Sep | Oct | Nov | Dec | Total |
| 40  |     |     |     |     |     |     |     |     |     |     |     | 40    |

| B-box Repairs |     |     |     |     |     |     |     |     |     |     |     |       |
|---------------|-----|-----|-----|-----|-----|-----|-----|-----|-----|-----|-----|-------|
| Jan           | Feb | Mar | Apr | May | Jun | Jul | Aug | Sep | Oct | Nov | Dec | Total |
| 0             |     |     |     |     |     |     |     |     |     |     |     | 0     |

| MIU Installations/Replacements |     |     |     |     |     |     |     |     |     |     |     |       |
|--------------------------------|-----|-----|-----|-----|-----|-----|-----|-----|-----|-----|-----|-------|
| Jan                            | Feb | Mar | Apr | May | Jun | Jul | Aug | Sep | Oct | Nov | Dec | Total |
| 44                             |     |     |     |     |     |     |     |     |     |     |     | 44    |

**Utility Locates Team:**

- Continued providing locates for ComEd pole replacement project at Beverly Road water tower.

| Utility Locates Team |     |     |     |     |     |     |     |     |     |     |     |       |
|----------------------|-----|-----|-----|-----|-----|-----|-----|-----|-----|-----|-----|-------|
| JULIE Locates        |     |     |     |     |     |     |     |     |     |     |     |       |
| Jan                  | Feb | Mar | Apr | May | Jun | Jul | Aug | Sep | Oct | Nov | Dec | Total |
| 214                  |     |     |     |     |     |     |     |     |     |     |     | 214   |

| Emergency JULIE Locates |     |     |     |     |     |     |     |     |     |     |     |       |
|-------------------------|-----|-----|-----|-----|-----|-----|-----|-----|-----|-----|-----|-------|
| Jan                     | Feb | Mar | Apr | May | Jun | Jul | Aug | Sep | Oct | Nov | Dec | Total |
| 31                      |     |     |     |     |     |     |     |     |     |     |     | 31    |

| Utility Joint Meets |     |     |     |     |     |     |     |     |     |     |     |       |
|---------------------|-----|-----|-----|-----|-----|-----|-----|-----|-----|-----|-----|-------|
| Jan                 | Feb | Mar | Apr | May | Jun | Jul | Aug | Sep | Oct | Nov | Dec | Total |
| 4                   |     |     |     |     |     |     |     |     |     |     |     | 4     |

**Facilities**

- Completed wiring project at Children's Advocacy Center;
- Repaired Fire Station 21 floor tile following plumbing repair;
- Conducted set up and take-down for Martin Luther King Jr. breakfast at Village Hall.

| Facilities                                     |     |     |     |     |     |     |     |     |     |     |     |       |
|--|-----|-----|-----|-----|-----|-----|-----|-----|-----|-----|-----|-------|
| Preventative Maintenance Program - staff hours |     |     |     |     |     |     |     |     |     |     |     |       |
| Jan  | Feb | Mar | Apr | May | Jun | Jul | Aug | Sep | Oct | Nov | Dec | Total |
| 95   |     |     |     |     |     |     |     |     |     |     |     | 95    |

**Fleet Services**

- Prepared new sidewalk snow machine unit #137 for service.

| Fleet Services                                       |     |     |     |     |     |     |     |     |     |     |     |       |
|--|-----|-----|-----|-----|-----|-----|-----|-----|-----|-----|-----|-------|
| Preventative Maintenance Program - Number of Repairs |     |     |     |     |     |     |     |     |     |     |     |       |
| Jan  | Feb | Mar | Apr | May | Jun | Jul | Aug | Sep | Oct | Nov | Dec | Total |
| 28   |     |     |     |     |     |     |     |     |     |     |     | 28    |

| Vehicles Sent for Warranty Repair |     |     |     |     |     |     |     |     |     |     |     |       |
|-----------------------------------|-----|-----|-----|-----|-----|-----|-----|-----|-----|-----|-----|-------|
| Jan                               | Feb | Mar | Apr | May | Jun | Jul | Aug | Sep | Oct | Nov | Dec | Total |
| 4                                 |     |     |     |     |     |     |     |     |     |     |     | 4     |

**Forestry**

- Conducted in-house training on best practices for tree trimming;

2. Attended bid openings for contract brush pick-up, tree trimming, and tree planting;
3. Continued preparations for upcoming contract tree trimming.

| Forestry                  |     |     |     |     |     |     |     |     |     |     |     |       |
|---------------------------|-----|-----|-----|-----|-----|-----|-----|-----|-----|-----|-----|-------|
| Customer Service Requests |     |     |     |     |     |     |     |     |     |     |     |       |
| Jan                       | Feb | Mar | Apr | May | Jun | Jul | Aug | Sep | Oct | Nov | Dec | Total |
| 4                         |     |     |     |     |     |     |     |     |     |     |     | 4     |

## Maintenance & Construction

### Storm Sewer Team:

1. Replaced Black Bear Park storm water restrictor plate.

| Storm Sewer Team            |     |     |     |     |     |     |     |     |     |     |     |       |
|-----------------------------|-----|-----|-----|-----|-----|-----|-----|-----|-----|-----|-----|-------|
| Feet of Storm Sewer Flushed |     |     |     |     |     |     |     |     |     |     |     |       |
| Jan                         | Feb | Mar | Apr | May | Jun | Jul | Aug | Sep | Oct | Nov | Dec | Total |
| 2,329                       |     |     |     |     |     |     |     |     |     |     |     | 2,329 |
| Catch Basin Rebuilds        |     |     |     |     |     |     |     |     |     |     |     |       |
| Jan                         | Feb | Mar | Apr | May | Jun | Jul | Aug | Sep | Oct | Nov | Dec | Total |
| 4                           |     |     |     |     |     |     |     |     |     |     |     | 4     |

### Construction/Maintenance Team:

1. Performed water and sewer service line abandonment at well #9 site (Charleston Lane);
2. Excavated for underground cable repair for emergency siren located at Lexington and Algonquin Road;
3. Oversaw contract water service replacement at 745 Alder Drive;
4. Performed electronic leak detection at various locations.

| Construction/Maintenance Team        |     |     |     |     |     |     |     |     |     |     |     |       |
|--------------------------------------|-----|-----|-----|-----|-----|-----|-----|-----|-----|-----|-----|-------|
| B-box Repair/Replacement             |     |     |     |     |     |     |     |     |     |     |     |       |
| Jan                                  | Feb | Mar | Apr | May | Jun | Jul | Aug | Sep | Oct | Nov | Dec | Total |
| 4                                    |     |     |     |     |     |     |     |     |     |     |     | 4     |
| Hydrant Replacement                  |     |     |     |     |     |     |     |     |     |     |     |       |
| Jan                                  | Feb | Mar | Apr | May | Jun | Jul | Aug | Sep | Oct | Nov | Dec | Total |
| 1                                    |     |     |     |     |     |     |     |     |     |     |     | 1     |
| Valve Repair/Replacement             |     |     |     |     |     |     |     |     |     |     |     |       |
| Jan                                  | Feb | Mar | Apr | May | Jun | Jul | Aug | Sep | Oct | Nov | Dec | Total |
| 2                                    |     |     |     |     |     |     |     |     |     |     |     | 2     |
| Water Main/Service Line Leak Repairs |     |     |     |     |     |     |     |     |     |     |     |       |
| Jan                                  | Feb | Mar | Apr | May | Jun | Jul | Aug | Sep | Oct | Nov | Dec | Total |
| 3                                    |     |     |     |     |     |     |     |     |     |     |     | 3     |

## Traffic Operations

### Pavement Maintenance Team:

1. Conducted unit 50 yard-man, semi-dump, and low-boy training;

2. Continued pot hole patching at various locations;
3. Provided saw cutting for water repair excavation.

| Pavement Maintenance Team      |     |     |     |     |     |     |     |     |     |     |     |       |
|--------------------------------|-----|-----|-----|-----|-----|-----|-----|-----|-----|-----|-----|-------|
| Tons of Hot Asphalt Installed  |     |     |     |     |     |     |     |     |     |     |     |       |
| Jan                            | Feb | Mar | Apr | May | Jun | Jul | Aug | Sep | Oct | Nov | Dec | Total |
| 0.0                            |     |     |     |     |     |     |     |     |     |     |     | 0.0   |
| Tons of Cold Asphalt Installed |     |     |     |     |     |     |     |     |     |     |     |       |
| Jan                            | Feb | Mar | Apr | May | Jun | Jul | Aug | Sep | Oct | Nov | Dec | Total |
| 16.0                           |     |     |     |     |     |     |     |     |     |     |     | 16.0  |

**Sign Team:**

1. Performed type-I sign reposting on Greenspoint Parkway;
2. Fabricated and installed decals on new Village vehicles.

| Sign Team                      |     |     |     |     |     |     |     |     |     |     |     |       |
|--------------------------------|-----|-----|-----|-----|-----|-----|-----|-----|-----|-----|-----|-------|
| Repaired/Replaced Signs        |     |     |     |     |     |     |     |     |     |     |     |       |
| Jan                            | Feb | Mar | Apr | May | Jun | Jul | Aug | Sep | Oct | Nov | Dec | Total |
| 9                              |     |     |     |     |     |     |     |     |     |     |     | 9     |
| Signs Fabricated and Installed |     |     |     |     |     |     |     |     |     |     |     |       |
| Jan                            | Feb | Mar | Apr | May | Jun | Jul | Aug | Sep | Oct | Nov | Dec | Total |
| 79                             |     |     |     |     |     |     |     |     |     |     |     | 79    |

**Street Light Team:**

1. Notified ComEd of street light outage under their jurisdiction.

| Street Light Team         |     |     |     |     |     |     |     |     |     |     |     |       |
|---------------------------|-----|-----|-----|-----|-----|-----|-----|-----|-----|-----|-----|-------|
| Customer Service Requests |     |     |     |     |     |     |     |     |     |     |     |       |
| Jan                       | Feb | Mar | Apr | May | Jun | Jul | Aug | Sep | Oct | Nov | Dec | Total |
| 6                         |     |     |     |     |     |     |     |     |     |     |     | 6     |
| Street Lights Repaired    |     |     |     |     |     |     |     |     |     |     |     |       |
| Jan                       | Feb | Mar | Apr | May | Jun | Jul | Aug | Sep | Oct | Nov | Dec | Total |
| 8                         |     |     |     |     |     |     |     |     |     |     |     | 8     |

**Water Operations**

**Operations Team:**

1. Installed projector and screen in Public Works training room;
2. Installed pump #1 at Barrington lift station;
3. Replaced media at force main vent fan on Route 59;
4. Repaired pump #1 valve at WDA lift station;
5. Pulled mixers at WDA for cleaning.



| Operations Team              |     |     |     |     |     |     |     |     |     |     |     |       |
|------------------------------|-----|-----|-----|-----|-----|-----|-----|-----|-----|-----|-----|-------|
| Resident Water Quality Tests |     |     |     |     |     |     |     |     |     |     |     |       |
| Jan                          | Feb | Mar | Apr | May | Jun | Jul | Aug | Sep | Oct | Nov | Dec | Total |
| 1                            |     |     |     |     |     |     |     |     |     |     |     | 1     |

**Sanitary Sewer Flow Management Team:**

1. Performed storm sewer televising, mapping, and debris clean-up related to the 2020 Road Reconstruction Program;
2. Assisted Operations Team with lift station maintenance;
3. Conducted sanitary sewer televising on Thacker Street and oversaw contract televising on Roselle Road and Illinois Boulevard.

| Sanitary Sewer Flow Management Team |     |     |     |     |     |     |     |     |     |     |     |       |
|-------------------------------------|-----|-----|-----|-----|-----|-----|-----|-----|-----|-----|-----|-------|
| Sewer Lines Flushed (feet)          |     |     |     |     |     |     |     |     |     |     |     |       |
| Jan                                 | Feb | Mar | Apr | May | Jun | Jul | Aug | Sep | Oct | Nov | Dec | Total |
| 2,200                               |     |     |     |     |     |     |     |     |     |     |     | 2,200 |
| Sanitary Main Inspections (feet)    |     |     |     |     |     |     |     |     |     |     |     |       |
| Jan                                 | Feb | Mar | Apr | May | Jun | Jul | Aug | Sep | Oct | Nov | Dec | Total |
| 495                                 |     |     |     |     |     |     |     |     |     |     |     | 495   |

# Fuel Use Report

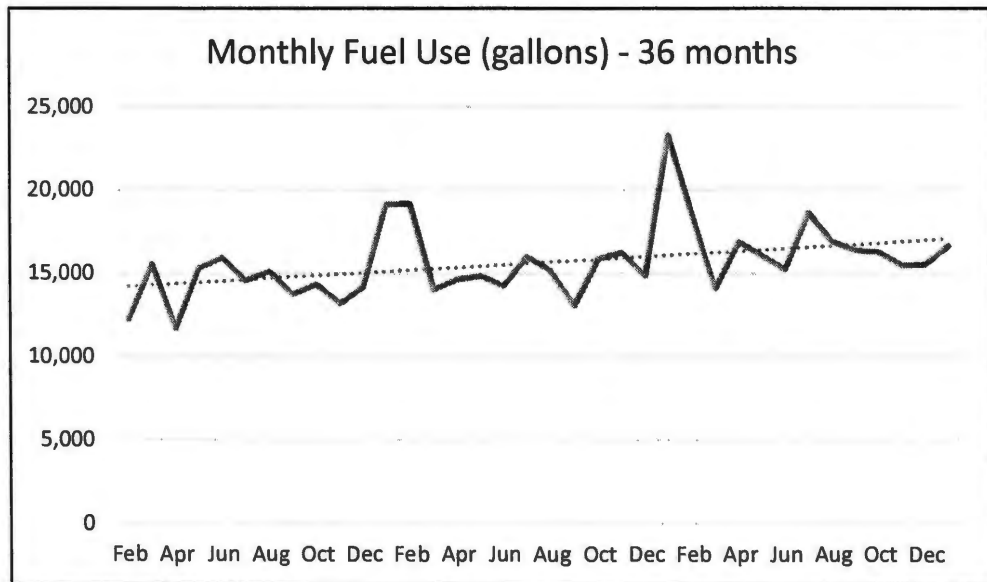
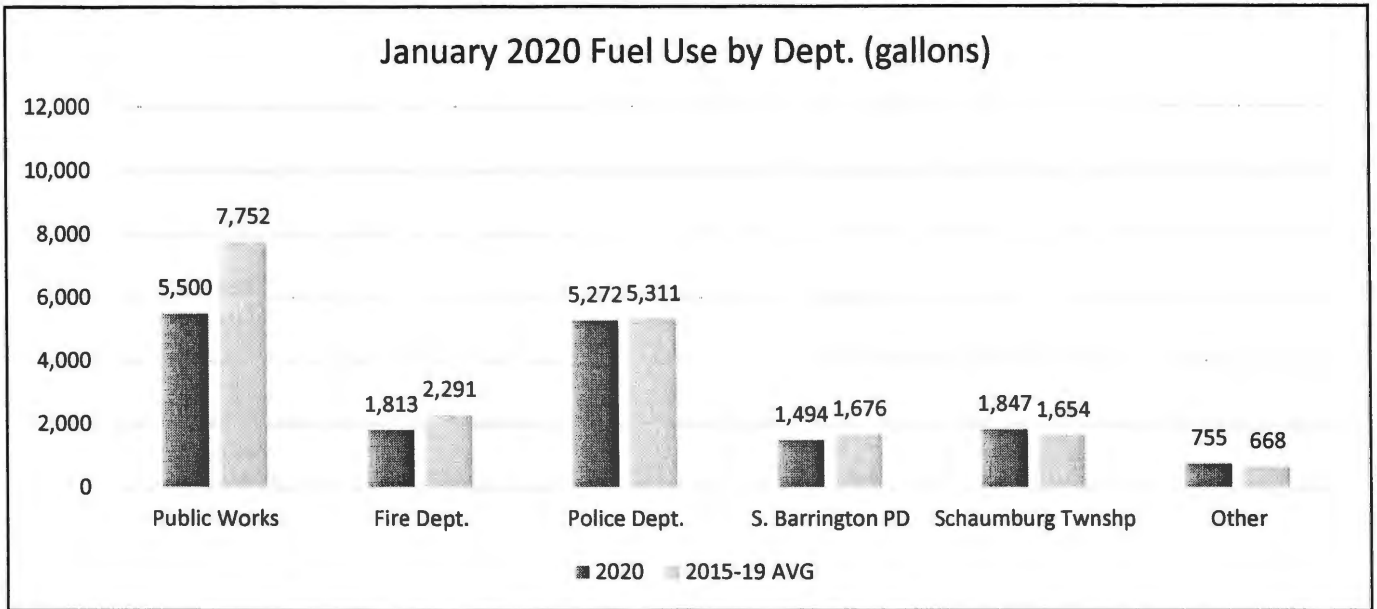

**ENGINEERING REPORT OF THE  
TRANSPORTATION AND ENGINEERING DIVISION  
DEPARTMENT OF DEVELOPMENT SERVICES  
FEBRUARY MONTHLY REPORT**

Attached is the Monthly Engineering Report of the Transportation and Engineering Division in the Department of Development Services for the period ending February 21, 2020.



---

Alan Wenderski, P.E.  
Village Engineer

**MISCELLANEOUS**

Summary of miscellaneous items:

- Participated in meetings for Community Development implementation
- Completed the Community Rating System (CRS) 2020 Recertification
- 11 permit inspections
  - Final inspection of closure of 28 various open permits
- 3 residential drainage investigations
- Engineering site plan review for:
  - 2480 Pembroke Avenue
  - SCA Storage Building
- Reviewed permits for:
  - 1 – Detached Garage/Addition
  - 1 – Patio
- Plan/permit review related to new single-family residential development:
  - 2 – Certificates of Occupancy

**PROJECT STATUS**

| <b>VILLAGE PROJECTS</b>                       |  |
|---|--|
| <b>PROJECT NAME</b>                           | <b>DESCRIPTION</b>   |
| <b>2019 Drainage Project</b>                  | Drainage work completed at both locations. Final restoration work and punch list to be completed in spring.<br><br>Village Project Manager: Oscar Gomez  |
| <b>2019 Street Revitalization Project</b>     | Remaining punch list work to be completed in spring.<br>Village Project Manager: Andy LoBosco  |
| <b>2020 Street Revitalization Project</b>     | Design ongoing. Scope also includes Illinois Blvd Storm Sewer Project. Project scheduled to be out to bid in late March.<br>Village Project Manager: Andy LoBosco  |
| <b>Almond/Audubon Culvert Replacement</b>     | Chastain completed response to initial IDOT comments, currently under review by IDOT. IDOT permit needed prior to the start of construction. A Lamp is prepared to start construction once IDOT permit is issued, pending weather.<br>Village Project Manager: Oscar Gomez |
| <b>Jones Road/Salem Drive STP Resurfacing</b> | Project eligible for federal STP funding through NWMC but not included in active list due to lack of funding. Phase 2 design ongoing to be prepared if funding becomes available. Civiltech contracted for design engineering.<br>Village Project Manager: Shelley Walenga |

| <b>VILLAGE PROJECTS</b>                         |  |
|---|--|
| <b>PROJECT NAME</b>                             | <b>DESCRIPTION</b>   |
| <b>Prairie Stone Stormwater Management Plan</b> | Contract with V-3 to revise/update the 2004 Prairie Stone Stormwater Management Plan. MWRD permit revision process ongoing.<br>Village Project Manager: Alan Wenderski |

| <b>COMMERCIAL PROJECTS</b>  |  |
|---|--|
| <b>PROJECT NAME</b>   | <b>DESCRIPTION</b>   |
| <b>7-11</b><br>2250 West Higgins Road   | Received Village Board approval on January 6 <sup>th</sup> . Awaiting permit approval from MWRD and IDOT. Reviewing cost estimate for calculation of project guarantee and fees.<br>Village Project Manager: Alan Wenderski  |
| <b>Adesa Auto Auction</b><br>5407 Trillium Boulevard                                      | Phase 1 - Executed Bill of Sale received from Adesa. Public acceptance process to resume in spring.<br>Phase 2 – Staff comments provided, awaiting response.<br>Village Project Manager: Alan Wenderski                      |
| <b>Aldi</b><br>375 West Higgins Road  | Work complete. Awaiting as-built drawings.<br>Village Project Manager: Terry White   |
| <b>Amita Behavioral Health Addition</b><br>1650 Moon Lake Boulevard                       | Preconstruction meeting held on January 23 <sup>rd</sup> . Project guarantee received. MWRD Earthwork/Foundation permit issued. Site mobilization underway.<br>Village Project Manager: Terry White                          |
| <b>BMO</b><br>1400 Gannon Drive (Current address)<br>1199 West Higgins Road (New address) | Received Village Board approval on December 2 <sup>nd</sup> . Awaiting permit approval from MWRD and IDOT. Reviewing cost estimate for calculation of project guarantee and fees.<br>Village Project Manager: Alan Wenderski |
| <b>Buona Beef</b><br>2500-2360 West Higgins Road  | Work on new building ongoing. Water/sewer service installations ongoing.<br>Village Project Manager: Terry White   |
| <b>Bystronic/Eagle Way Extension</b><br>2200 Central Road                                 | Temporary CO issued. Eagle Way open to traffic. Final completion and final inspection to occur in spring.<br>Village Project Manager: Terry White  |
| <b>Greenspoint Amenities</b><br>2800 West Higgins Road<br>2300 Barrington Road            | Exterior site improvements. Work ongoing.<br>Village Project Manager: Terry White  |
| <b>Hoffman Plaza</b><br>Higgins and Roselle   | Phase 1 - Completion of detention basin improvements ongoing.<br>Outlot 4 – Work ongoing. Water service installed.<br>Village Project Manager: Terry White   |

| <b>COMMERCIAL PROJECTS</b>   |   |
|--|---|
| <b>PROJECT NAME</b>  | <b>DESCRIPTION</b>  |
| <b>Holiday Inn Express</b><br>5235 Prairie Stone Parkway                 | Interior building work ongoing. Site work on hold for winter.<br><br>Village Project Manager: Terry White   |
| <b>Schaumburg Township Parking Lot Expansion</b><br>1 Illinois Boulevard | Reviewing as-built drawings. Received signed RFI for closure of MWRD permit.<br><br>Village Project Manager: Terry White  |
| <b>South Ridge Park</b><br>1450 Freeman Road                             | Hoffman Estates Park District – Park and site improvement. Awaiting issuance of MWRD permit.<br><br>Village Project Manager: Alan Wenderski   |
| <b>Winston Knolls School Playground</b><br>2353 Hassell Road             | Received Village Board approval on December 16 <sup>th</sup> . Project guarantee received. Awaiting scheduling of preconstruction meeting.<br><br>Village Project Manager: Alan Wenderski |

| <b>RESIDENTIAL PROJECTS</b>   |   |
|---|---|
| <b>PROJECT NAME</b>   | <b>DESCRIPTION</b>  |
| <b>Amber Meadows</b><br>NE Corner of Essex Drive and Beacon Pointe Drive  | Home building ongoing.<br><br>Village Project Manager: Terry White  |
| <b>Bergman Pointe</b><br>NW Corner of Ela Road and Algonquin Road         | Home building ongoing. Signal modifications at Ela/Algonquin substantially complete. Final inspection for public improvements suspended until spring.<br><br>Village Project Manager: Terry White |
| <b>Devonshire Woods</b><br>SW Corner of Shoe Factory Road and Essex Drive | Home building ongoing. Final inspection for subdivision acceptance completed. Punch list work on hold until spring.<br><br>Village Project Manager: Terry White/Oscar Gomez                       |